

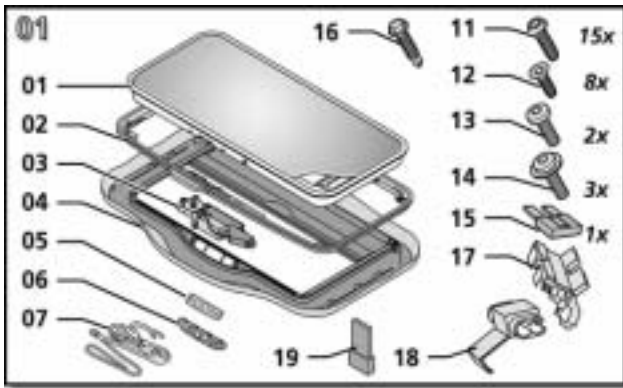

HOLLANDIA 300 MEDIUM INSTALLATION MANUAL

Installation Instructions – Hollandia 300 Medium



Before beginning the installation, make sure all required parts are in the box.

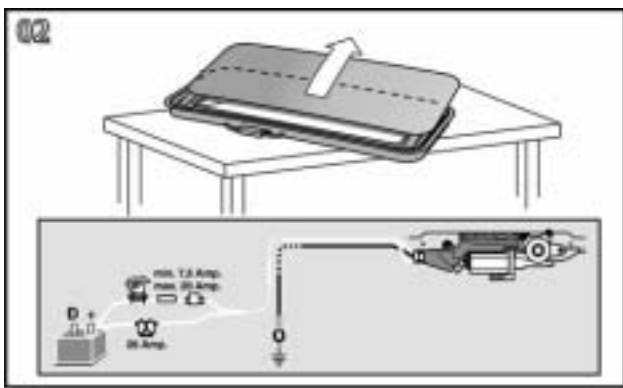

Check the functionality of the sunroof.
 Note: The sunroof needs to be calibrated first.

- Close the sunroof completely by continuous function. Hold the switch for at least 5 seconds.
- Open the roof completely. The roof will be positioned to its full open position (this can be recognized by a click). The SCU has now been calibrated. To check this, confirm the sunroof can be operated by soft touch.

Look in the Webasto Hollandia application list for the correct installation information. If the installation information is not available, please continue with instructions 03 & 04. If available, skip to instruction 05.

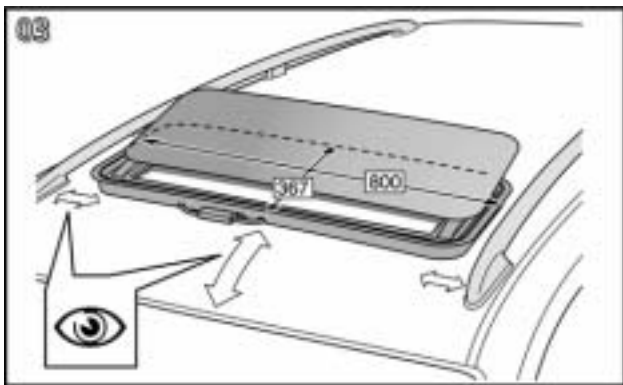

Check the outside of the vehicle. Take the following issues into consideration:

- Curvature of car roof
- Width and length of roof skin
- Presence of roof racks
- Presence of rood profiles

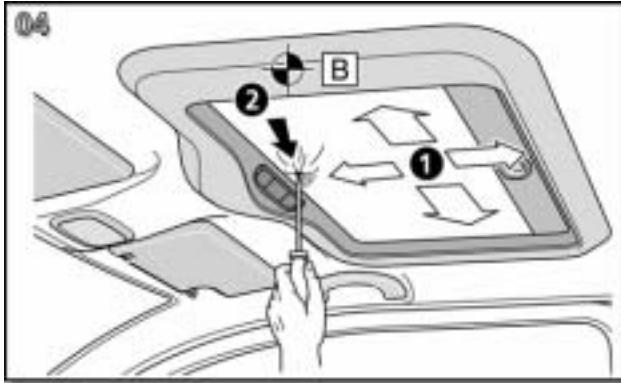

Position the trimshell against the headliner of the vehicle. Use an awl to mark reference point B.

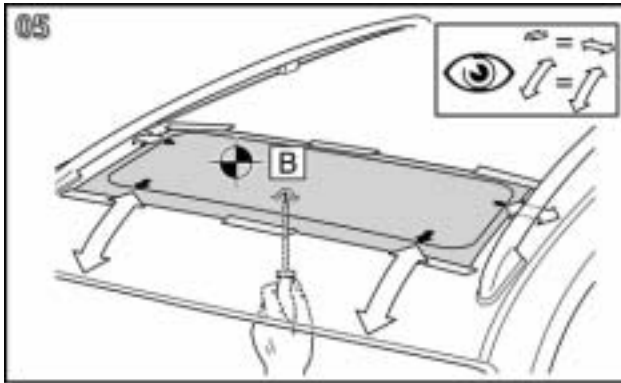

Align the paper instruction template on the roof skin and apply paper masking tape to fix the template in place. Reference B should correspond with reference point B of the paper template.

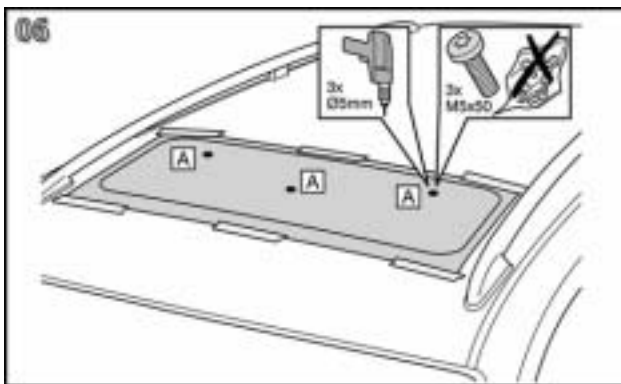

Drill the three holes through the roof skin and headliner. Use a 5 mm bit.

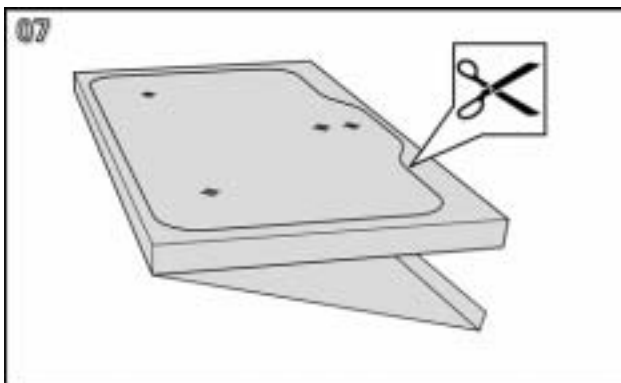

Cut out the interior template from the cardboard box.

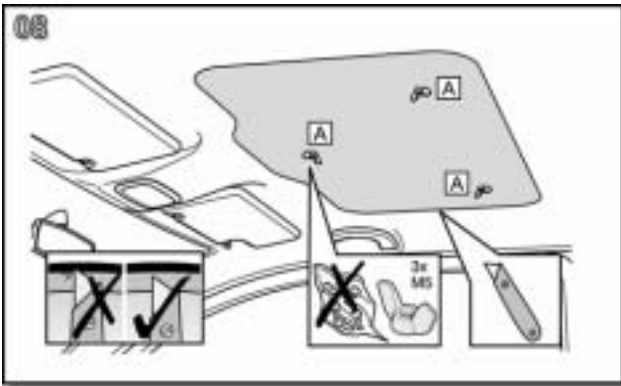

Attach the cardboard template with three screws and wing nuts. Screws are not supplied. Cut-out the headliner with a sharp Stanley knife.

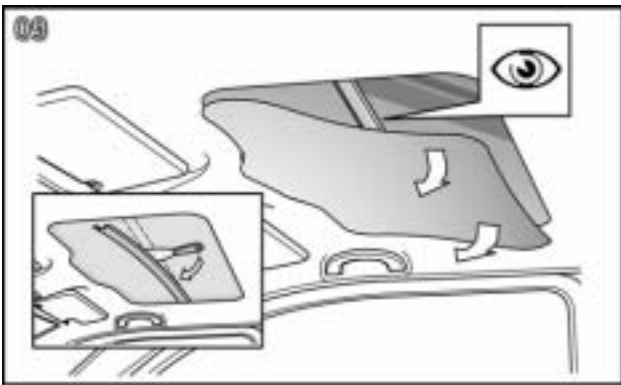

Remove the headliner. Remove sound proofing material and roof stiffeners. The under side of the car roof should be free of any remains of mastic.

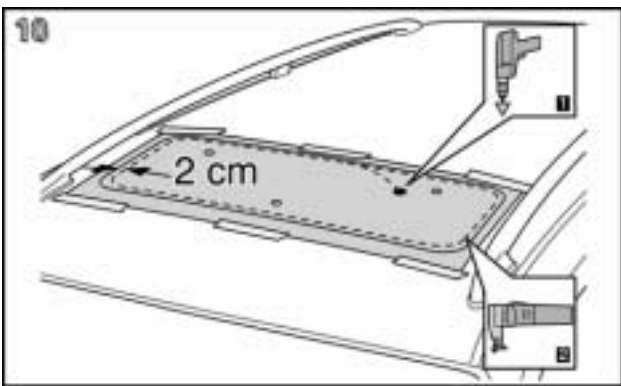

Cut the hole in the roof. To prevent distortion the first cut should be .75 inch inside the final cut line.

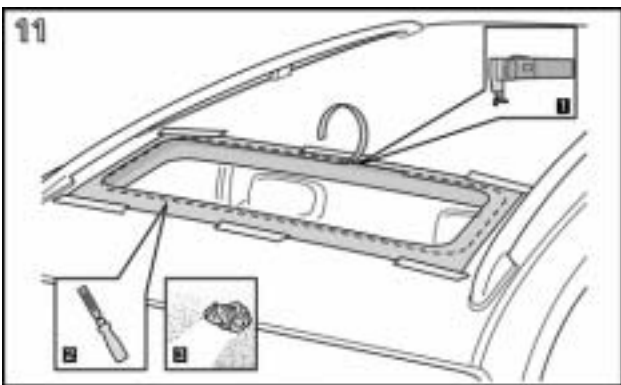

Cut the final hole on the cut line.

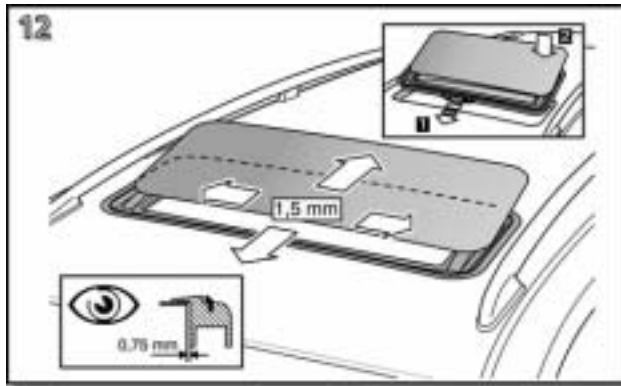

Check the size of the aperture. The clearance on both sides should be approx. .03 in.

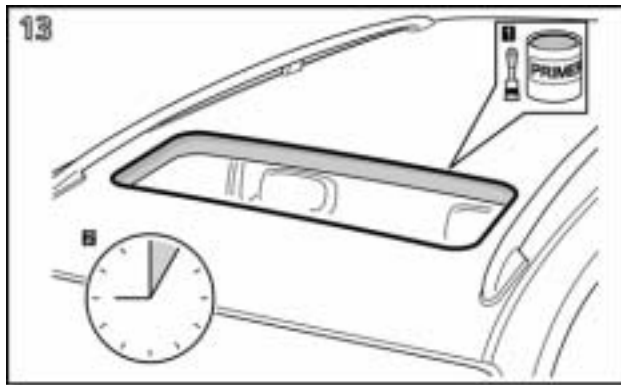

Protect the cut edge with anti corrosion primer.

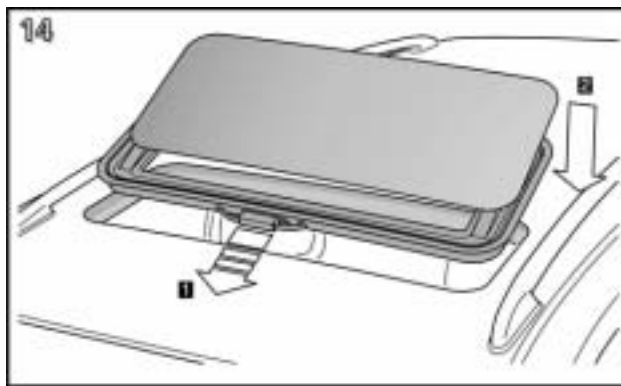

Place the sunroof in the roof aperture.
Lift the rear and slide it forward in the roof aperture.
Lower the rear of the sunroof.

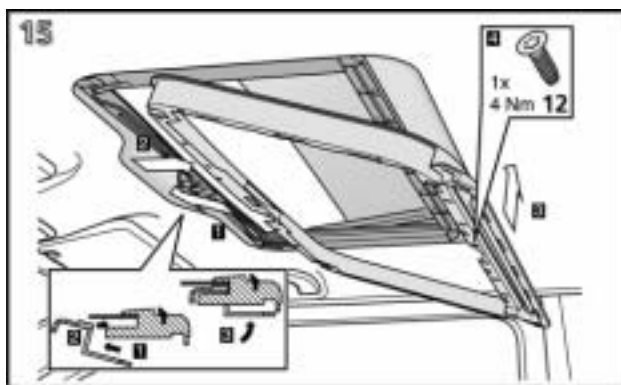

Install the clamp frame. By holding the clamp frame at an angle of 45 degrees, hook the front of the clamp frame over the upper frame and push the rear upwards.

Apply the rear middle screw to prevent the clamp frame from falling down.

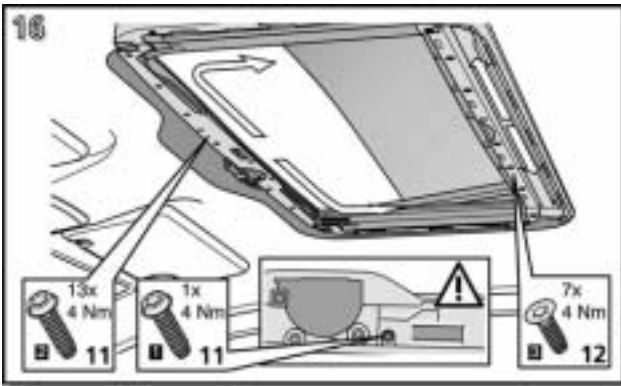

Mount the clamp frame screws. It is important to install the middle front screw first. This screw centers the clamp frame.

- Apply black screws along the front and sides.
- Apply the silver colored screws along the rear.

See chapter “additional instructions for installation” for details.

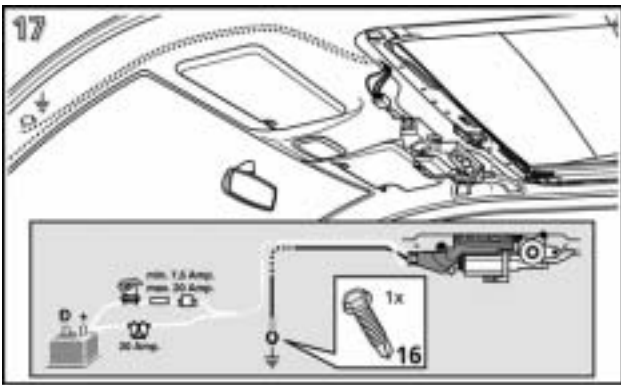

Make electrical connections.

- Red wire: +30 Constant
- Red/black wire: +15 Ignition controlled.
- Green: ground

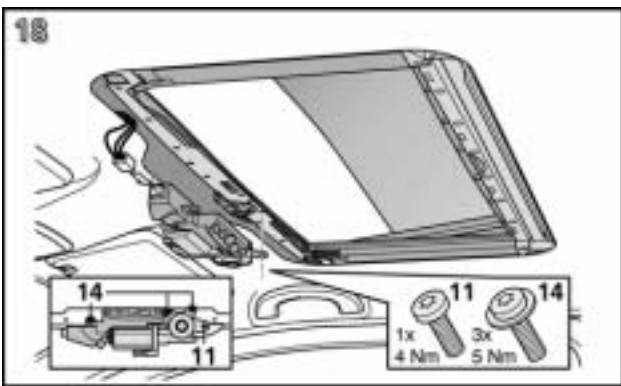

Install the motor and the sunroof control unit. Make sure that the spline of the motor shaft is located correctly in the gearwheel. Torque 5 Nm.

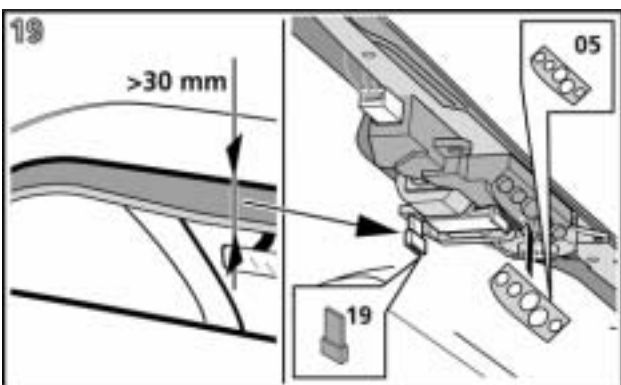

Apply the velour label over the control buttons. Mount the elongation bar if necessary.

See chapter “additional instructions for installation” for details.

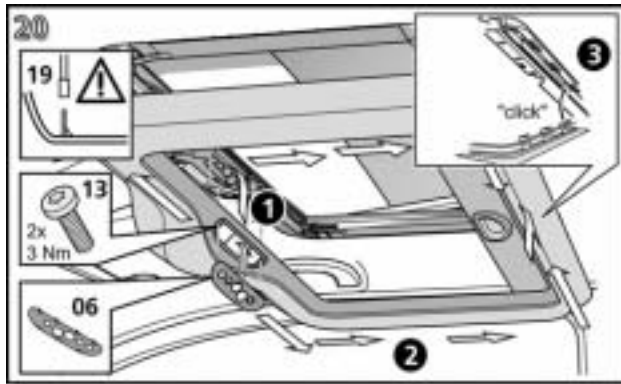

Mount the trimshell. Start at the front and make sure that all tabs are fixed properly.

Fix the sides and the rear of the trimshell. If applicable the elongation bar (number 19) should be positioned in place.

Install the trimshell attaching screws and mount the control cover.

See chapter "additional instructions for installation" for details.

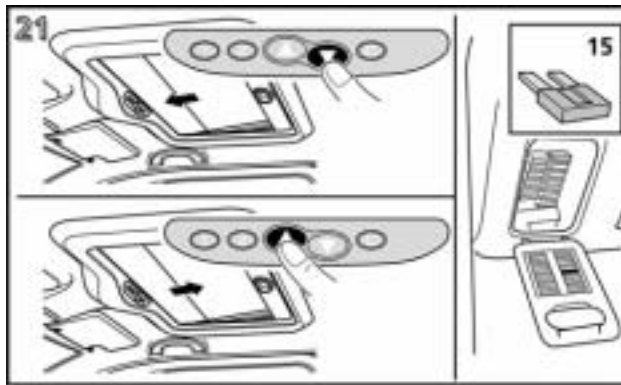

Mount the fuse and calibrate the sunroof.

- Close the sunroof completely by continuous function. Hold the switch for at least 5 seconds.
- Open the roof completely. The roof will be positioned to its full open position (this can be recognized by a click). The SCU has now been calibrated. To check this, confirm the sunroof can be operated by soft touch.

Soft headliner only:

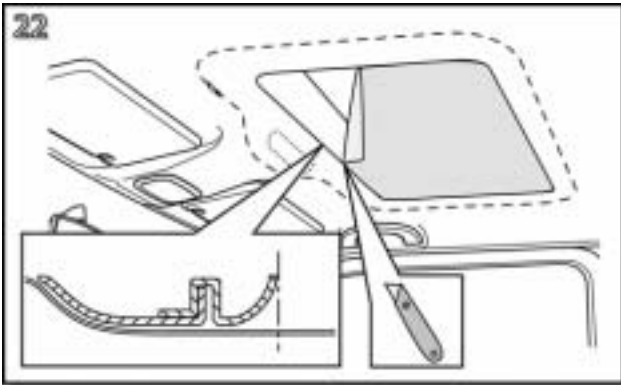

Cut out the hole in the soft headliner. Cut along the inside of the trimshell.

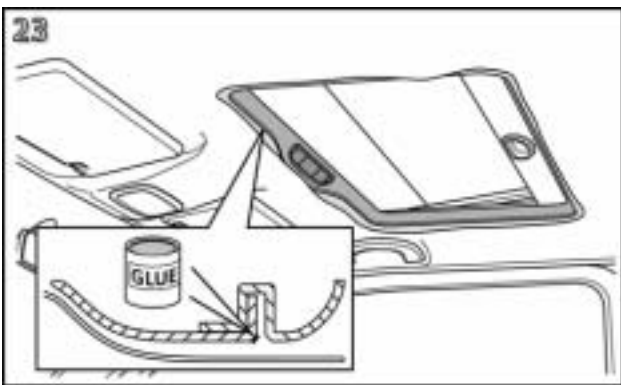

Apply glue to the headliner material and trimshell.

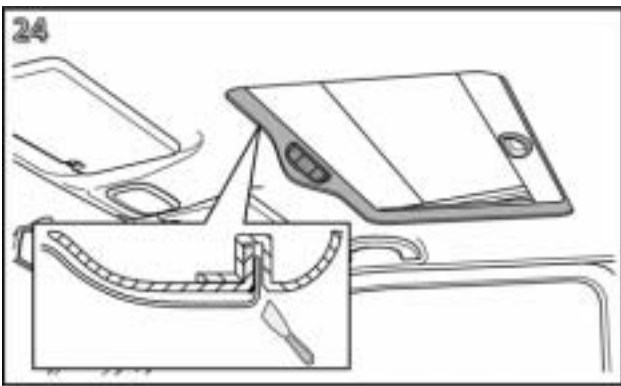

Stretch the headliner. Use a spatula with round corners to push the headliner material into the groove of the trimshell.

3. Additional instructions for installation

Dry seal:

The Hollandia 300 medium is provided with a dry seal. The dry seal is pre-installed on the upper frame and provides water tight sealing against the vehicles roof skin. The new seal offers unique advantages:

- Shorter installation time; No mastic or foam strip needs to be applied on the upper frame.
- No clean up after installing the sunroof.

Although the dry seal is made of high resistant flexible rubber, special precautionary measures need to be taken. Before placing the sunroof in the roof aperture, be sure that the edges of the roof aperture are rounded with a file. A sharp edge can damage the dry seal. Also dirt and burs need to be removed before installing the sunroof.

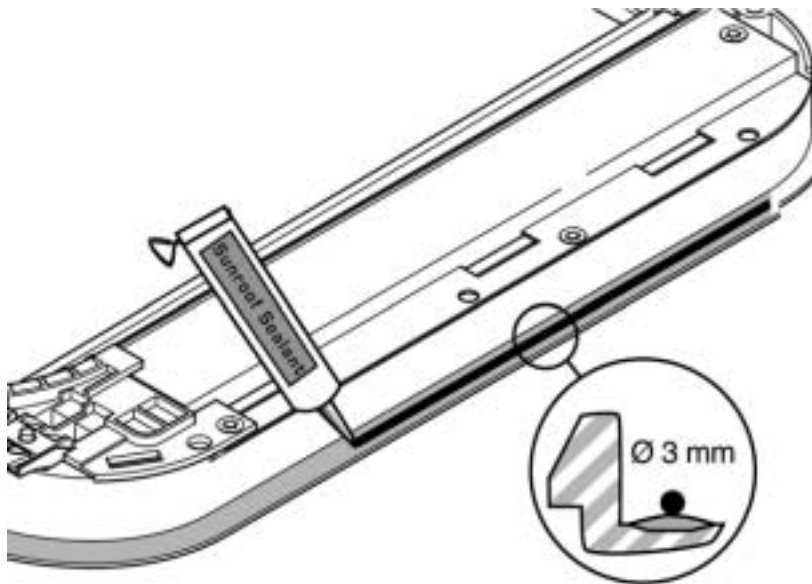

Installation of clamp frame:

Like all other spoiler sunroofs of the Webasto Hollandia assortment, a clamp frame is provided to press the upper frame against the roof skin.

Proceed as follows for a correct installation:

Holding the clamp frame at an angle of 45 degrees, hook the front over the upper frame. Push the rear upwards and mount the middle screw at the back to prevent it from falling (do not tighten it completely). In some cases it is necessary to pull the headliner downwards when installing the clamp frame. The center front at the notch in the clamp frame needs to align with the center rib on the upper frame. Align these and mount the center screw. Now the remaining clamp frame screws can be installed.

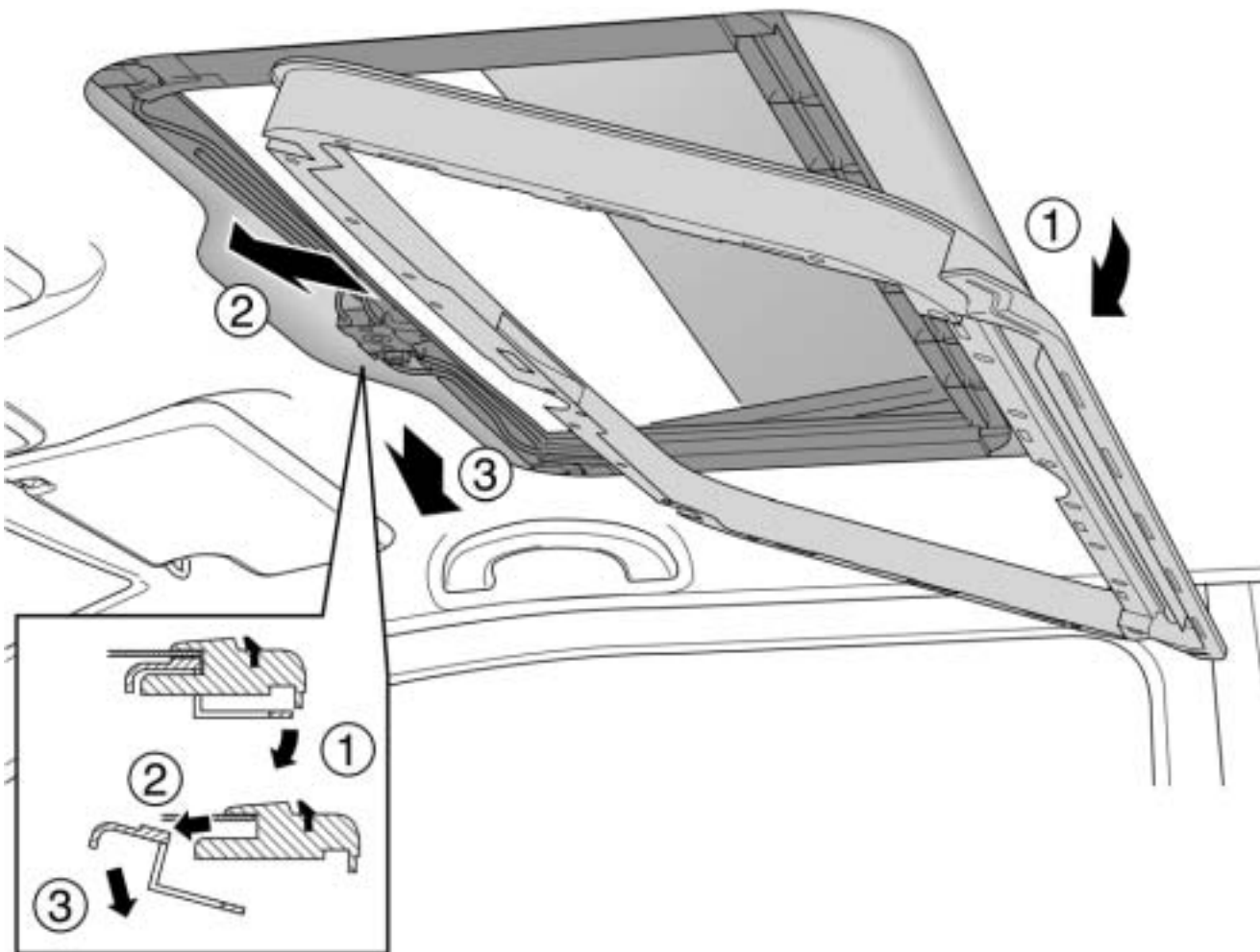

Installation of hard headliner trimshell:

The Hollandia 300 medium can be finished with the standard hard headliner trim shell or with a soft headliner. In both situations the hard headliner trim shell needs to be installed.

Hard headliner trimshell version:

Before mounting the trim shell, check if the stabilization bracket is placed in the correct position. The correct position is in the middle of the motor. For the installation of the trim shell, start at center front at the control panel. Check if the vertical edge center front is positioned in the stabilization bracket. If it is not the control buttons are not accessible and are too deep behind the control panel cover!

Push the trim shell against the frame around the entire aperture and install the two clamp frame screws and control panel cover.

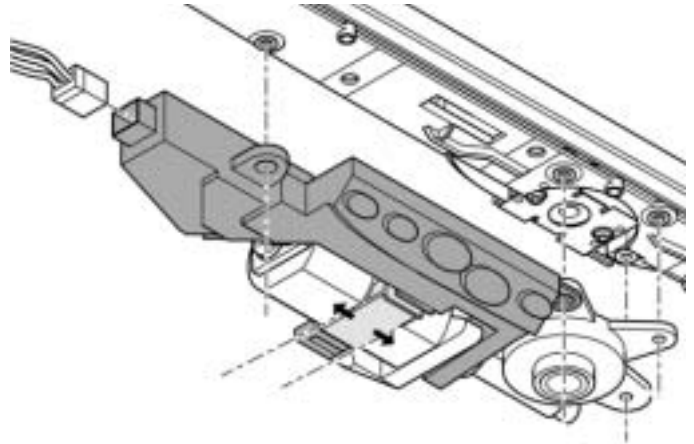

Attention:

When the height between the roof skin and the bottom of the vehicle's headliner is too large, it may be necessary to pull the trim shell downwards, so it can follow the shape of the roof skin. Along the front side this can be done by applying the elongation bar at center front between the trim shell and the motor. The elongation bar (see installation instructions figure 20) can be installed after the trim shell is installed and can be customized by the installer.

Soft headliner version:

When installing the soft headliner version it is necessary to install the trim shell first. Depending on the vehicle it may be necessary to remove the flexible outer lip. This is done when the sunroof is installed far forward or if the trim shell is interfering with the interior light and/or the sun visors. The trim shell is installed in the same way as for the hard headliner trim shell version. The new soft headliner can now be applied. The aperture finishing process is as follows:

- Cut out the headliner. For reference cut along the inside of the trim shell.
- Apply glue to the slanted surface of the trim shell and the headliner material.
- Stretch the headliner material and stick it to the trim shell. Use a spatula with rounded corners to push the remaining material into the groove.

Attention:

Installing the elongation bar may not be necessary.

4. Operating instructions

4.1 Control panel

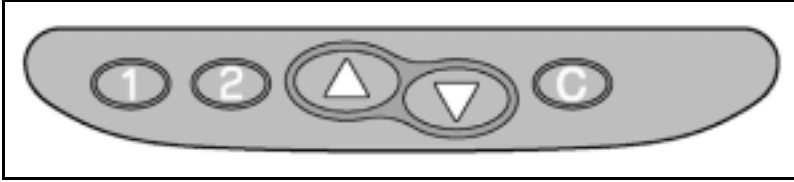



Fig. 1.1

-  1 Pre-set position 1
-  2 Pre-set position 2
-  ▲ Tilt / Open
-  ▼ Move forwards
-  C One touch close

4.2 Program sunroof

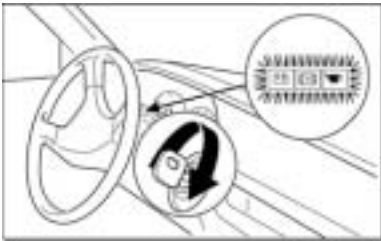

Fig. 2.1

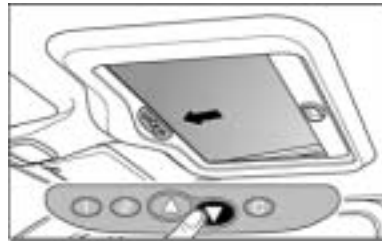

Fig. 2.2

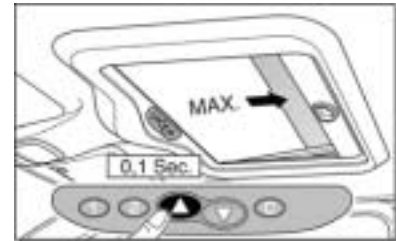

Fig. 2.3

- 2.1: Turn on the ignition
- 2.2: Close the sunroof completely
- 2.3: Open the sunroof completely

4.3 Opening of sunroof



Fig. 2.4

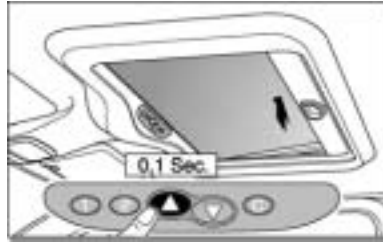

Fig. 2.5

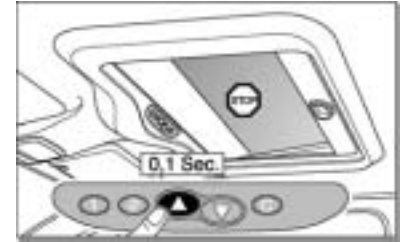

Fig. 2.6

Opening the sunroof in sliding position

2.4: Turn on the ignition

2.5: Push the open button briefly, the sunroof will cycle to the fully open position.

2.6: Push the open button again, the sunroof stops in that position.



Fig. 2.7



Fig. 2.8

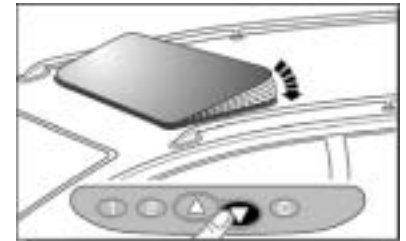

Fig. 2.9

Opening sunroof in tilt position

2.7: Turn on the ignition

2.8: Push and hold the open button, the sunroof will stop in the tilt position.

2.9: By pressing the button with continuous control, the panel closes to lower preset tilting positions.

4.4 Closing of sunroof

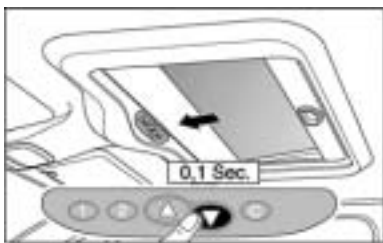

Fig. 2.10

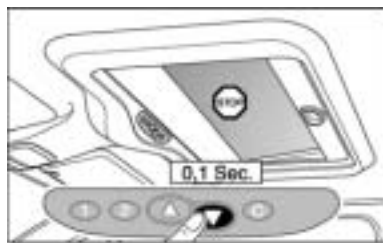

Fig. 2.11

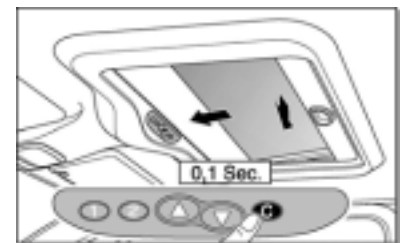

Fig. 2.12

2.10: By pressing the switch using soft touch control, the panel will close

2.11: Pressing the button again will stop the panel

2.12: When pressing the (C) button, the panel will close completely regardless of the panel position.

4.5 Program two pre-set positions

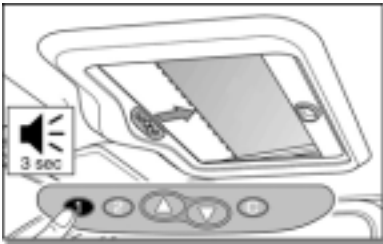

Fig. 2.13

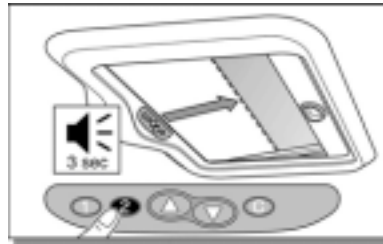

Fig. 2.14

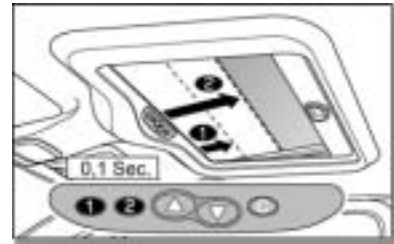

Fig. 2.15

2.13: Place the panel in the first desired position and press button (1) to store this position under button 1.

2.14: Place the panel in the second desired position and press button (2) to store this position under button 2.

2.15: By pressing on button (1) or (2), the panel will stop in the programmed preset position.

4.5 Auto close

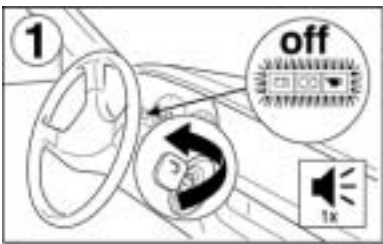

Fig. 2.16

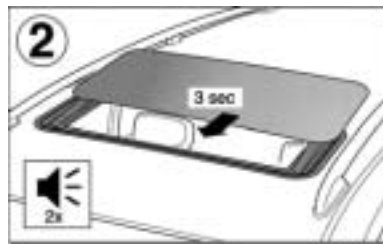

Fig. 2.17

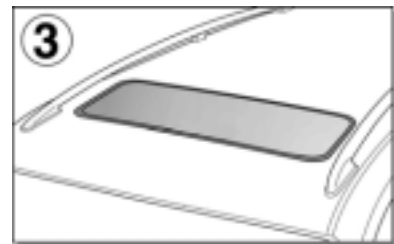

Fig. 2.18

2.16: After turning off the ignition the sunroof will beep once to tell you that it will close after 3 seconds.

2.17: After 3 seconds the panel will close.

2.18: Roof is closed.

4.5 Jamming protection

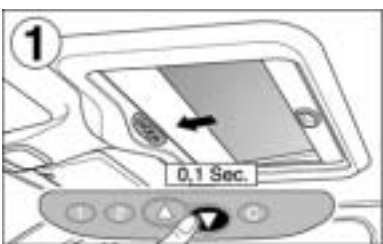

Fig. 2.19



Fig. 2.20

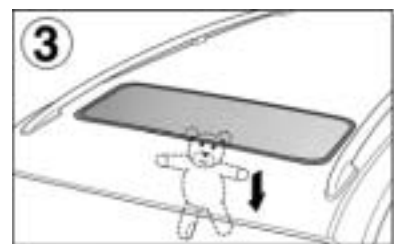

Fig. 2.21

2.19: When closing the sunroof...

2.20: ...the sunroof will open automatically when the panel encounters an obstacle.

2.21: When the obstacle is removed, the panel will close completely.

4.6 Operation of sunshade



Fig. 3.1

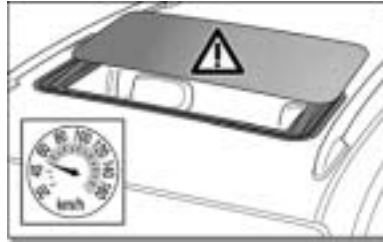

Fig. 3.2

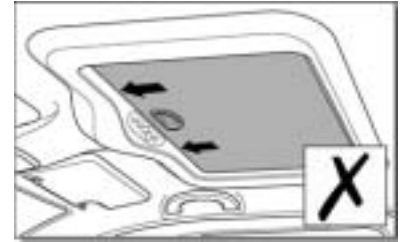

Fig. 3.3

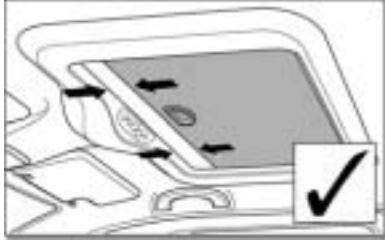

Fig. 3.4

3.1: The sunshade can be positioned in any desired position.

3.2: When driving at a speed of over 35Mph with the panel open: The sunshade should be opened approx. 1.5 inches.

4.7 Special notes

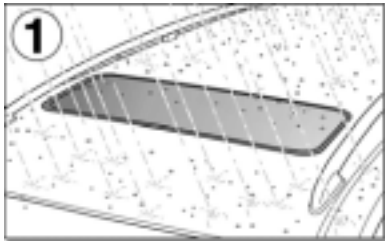

Fig. 4.1



Fig. 4.2

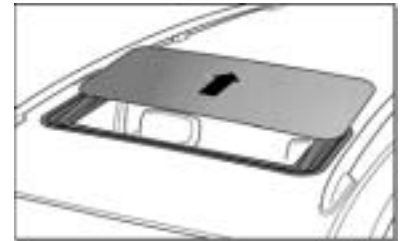

Fig. 4.3



Fig. 4.4



Fig. 4.5

4.1: Do not open the sunroof when it is raining

4.2: Drive for at least 5 minutes to dry the glass panel.

4.3: When the water drops are blown off the glass panel you can open the sunroof.

4.4: Never put any part of your body through the sunroof opening.

4.5: If your luggage rack has adjustable cross car supports, be sure they are not in the sunroof's path before opening the sunroof.



Webasto Product N.A., Inc.



Org. 0X/200X Rev. 0X/200X

P/N 5000XXXA