

3.5 Mechanism, upper frame guide insert and drive cables.

Dismount the sunroof as described in 2.1.1

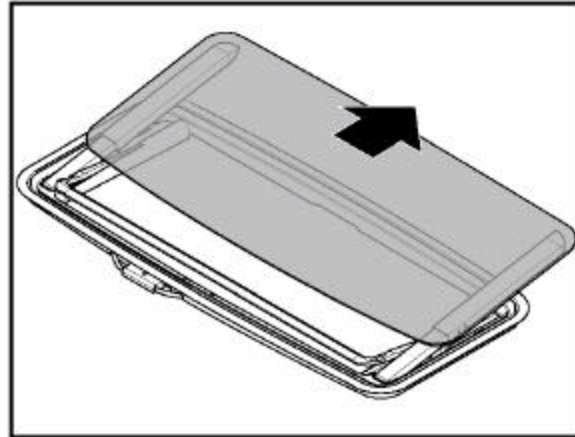

1. Open the glass panel in fully.

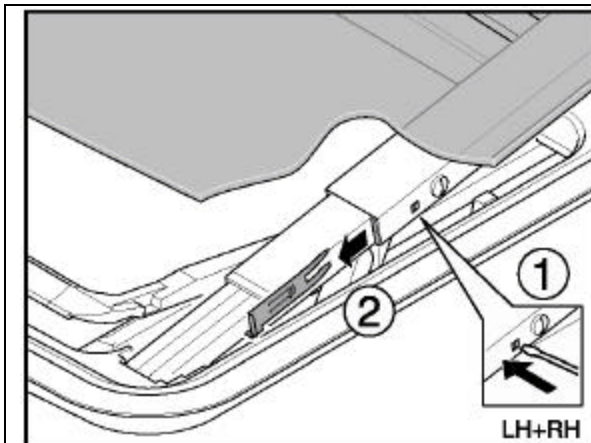

2. Unlock by pushing the screwdriver in the unlocking hole. Slide the locking part forward out of the mechanism. Repeat this at the other side.

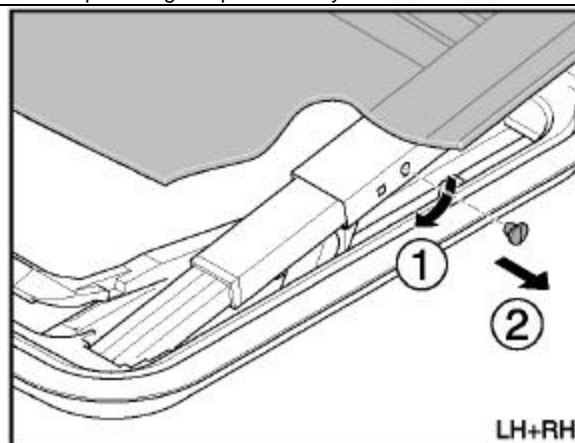

3. Turn the glass panel fixation pin by positioning the flat side parallel with the glass panel and remove it. Repeat for the other side.

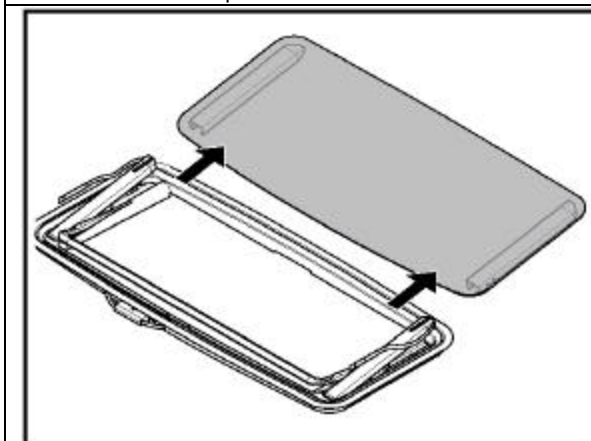

4. Carefully slide the panel parallel away from the mechanism.

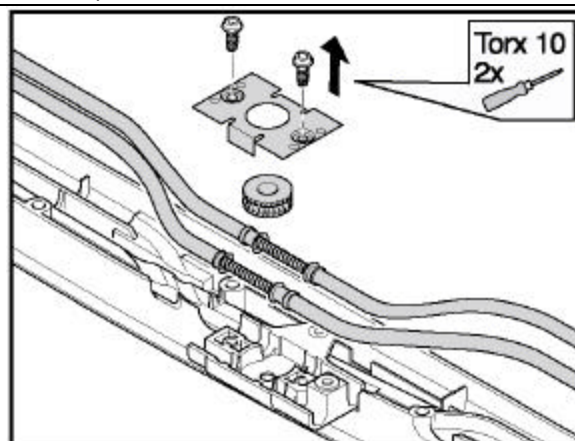

5. Remove gearwheel housing and gearwheel.

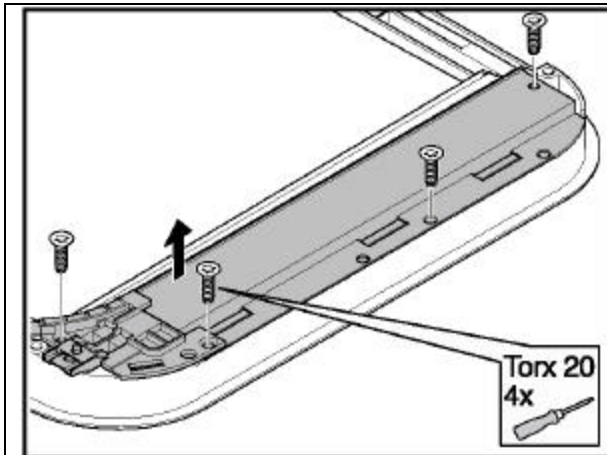

6. Remove the 4 mechanism fixation screws.

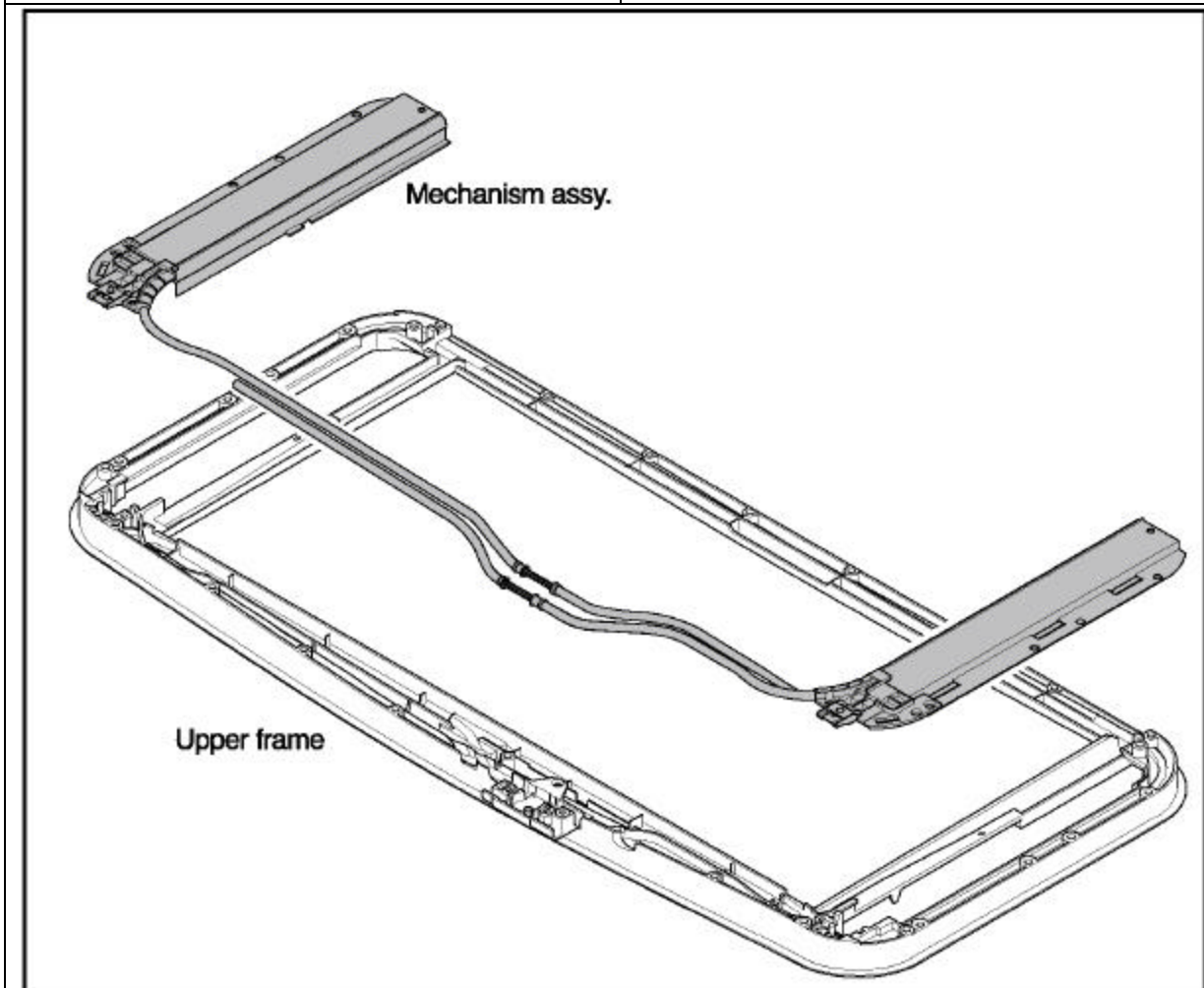

7. The mechanism and upper frame can now be exchanged. Continue with instruction no.: 8.23 to install the sunroof. If applicable, inspect the new mechanism and upper frame before installation. Continue with the following instructions to exchange the drive cables and guide insert.

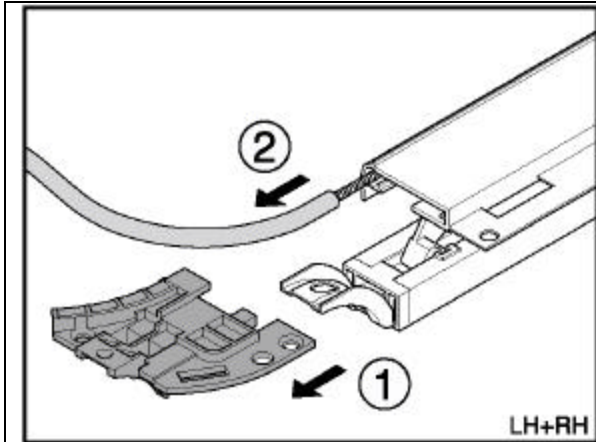

8. Remove the hinge mounting block and driving tubes.

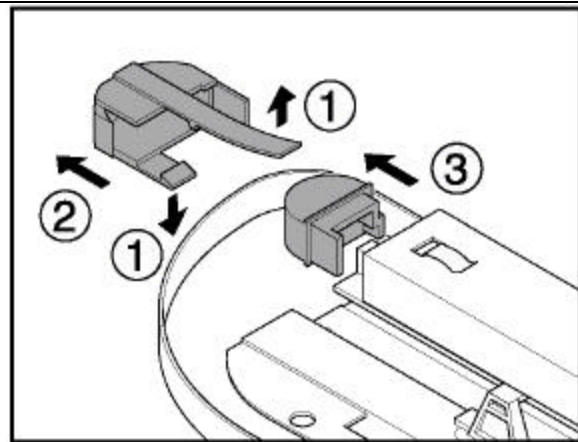

9. Take the hairpin cap from the mechanism by simultaneously lifting the lip upwards and pulling the hairpin cap rearward. Remove the hairpin block.

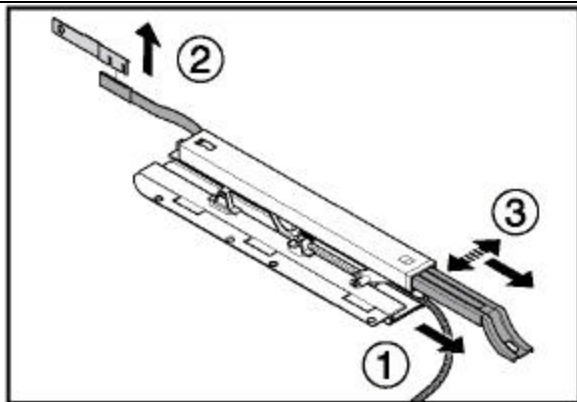

10. Pull the drive cable to place the mechanism in the tilt position. Remove the fixation plate from the hinge profile. Pull the hinge profile out of the mechanism completely. If the hinge profile blocks, simultaneously pull and move the hinge profile side ways.

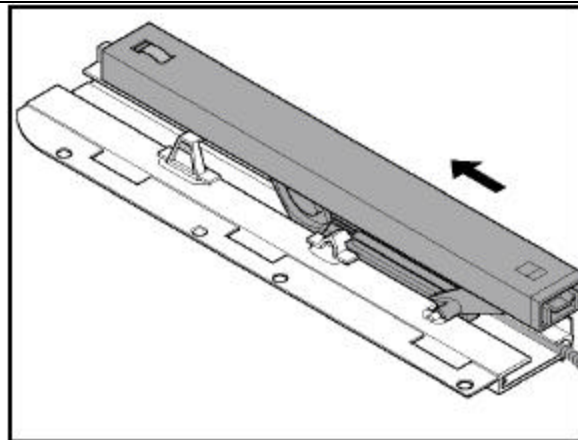

11. Slide the complete mechanism rearwards out of the guide rail.

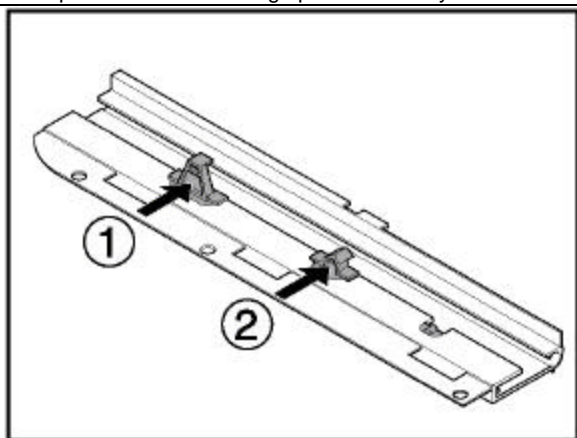

12. Remove the guide insert. Carefully push the guide insert inward on position 1 and 2.

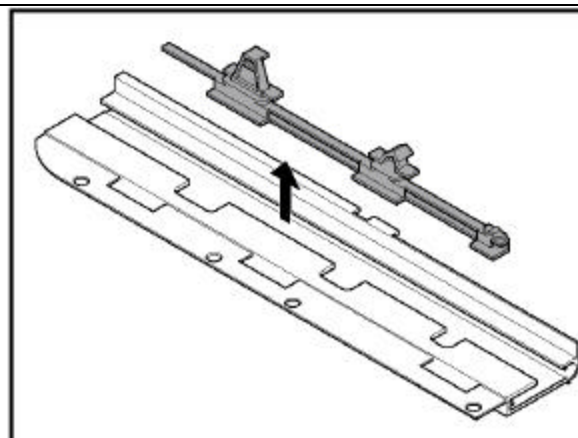

13. Take the guide insert out of the mechanism rail.

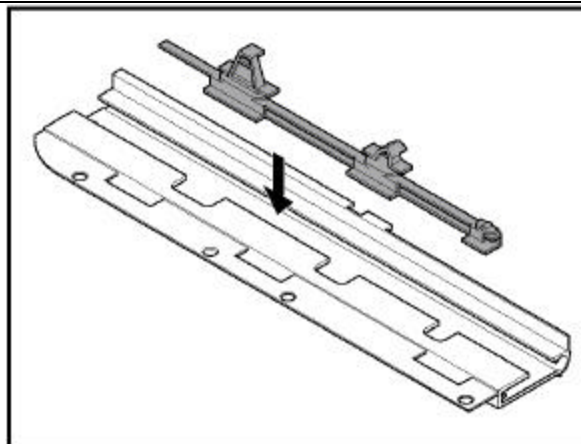

14. Inspect the new guide insert. Place the guide insert in the mechanism rail.

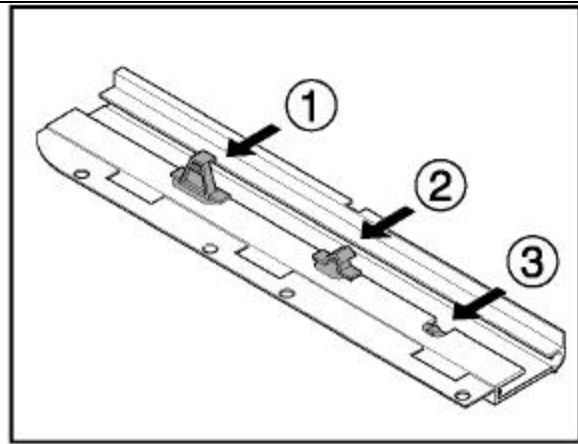

15. Secure the guide insert by pushing the guide insert sideways until it clicks. Continue with instruction 8.19 to install the sunroof. Continue to dismantle the mechanism and to replace the drive cables.

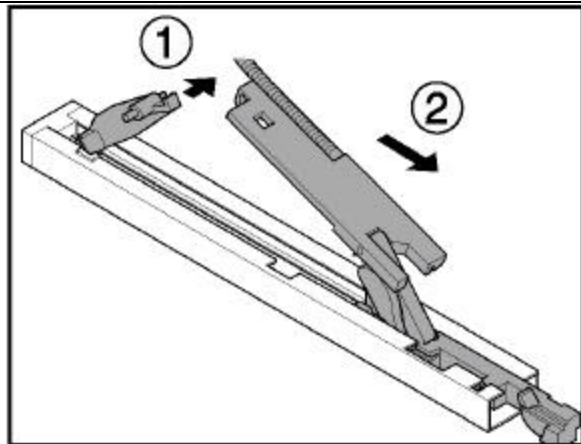

16. Disconnect front lever from the driving slide and slide the driving slide completely out of the driving profile.

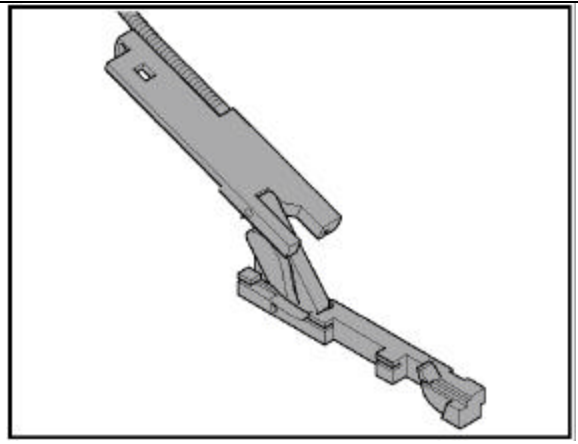

17. Inspect the new drive cable kit before installation.

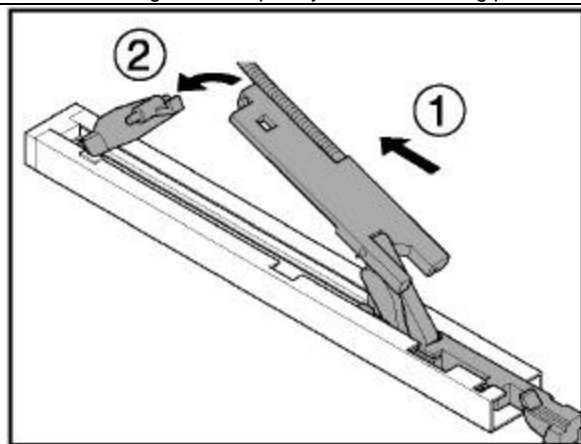

18. Slide the driving slide in the driving profile. Lubricate the driving profile with oil. Connect the driving slide with the front lever.

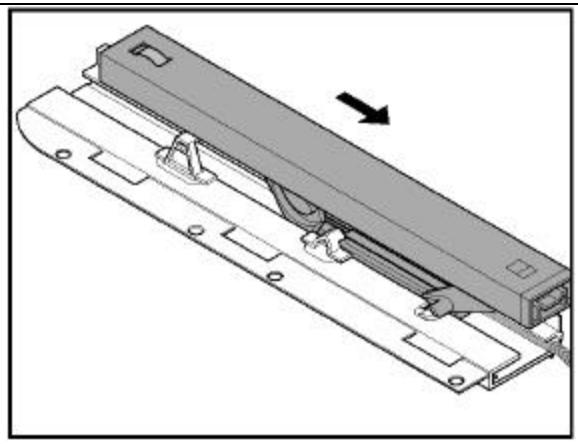

19. Slide the assembled mechanism in the mechanism rail.

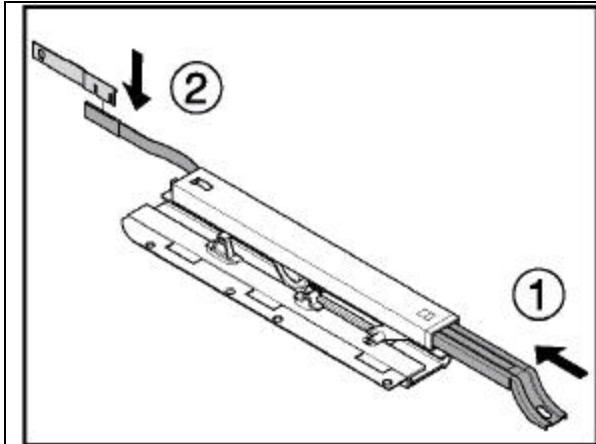

20. Slide the hinge profile in the driving profile and place the fixation plate.

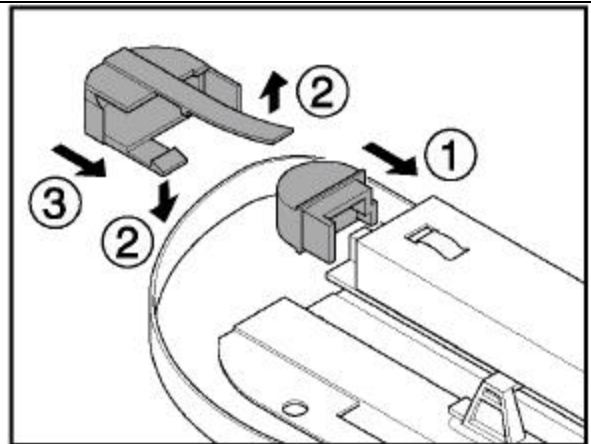

21. Slide the hinge profile in the driving profile and place the fixation plate.

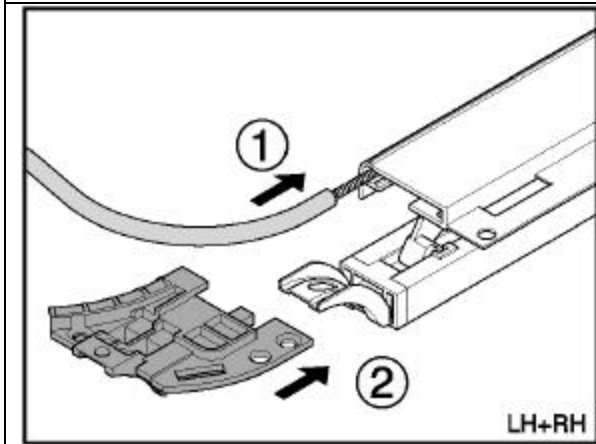

22. Place the cable tubes over the drive cable and make sure that the steel tube is pushed into the mechanism guide. Mount the hinge mounting block.

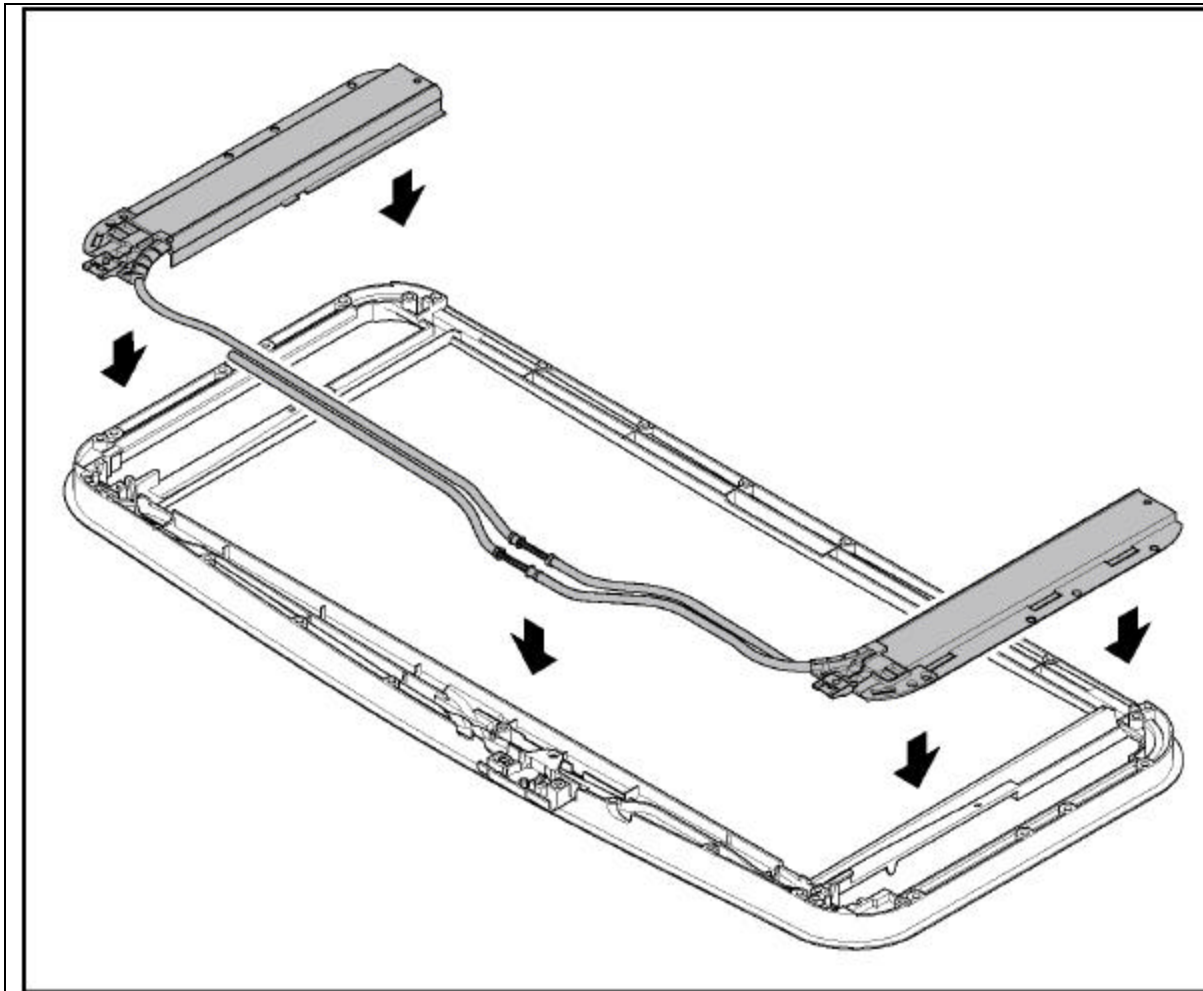

23. The complete mechanism assembly is now ready to be installed on the upper frame.

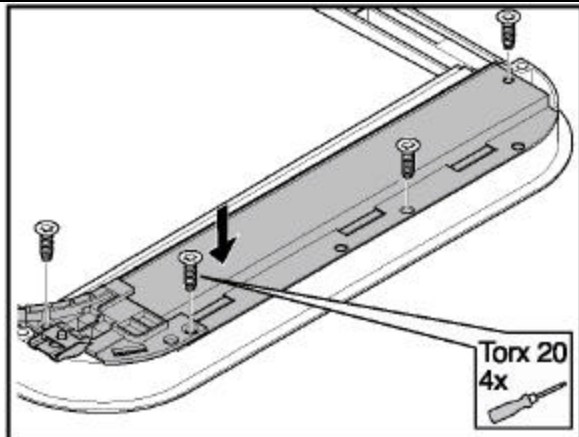

24. Mount the mechanism on the upper frame.

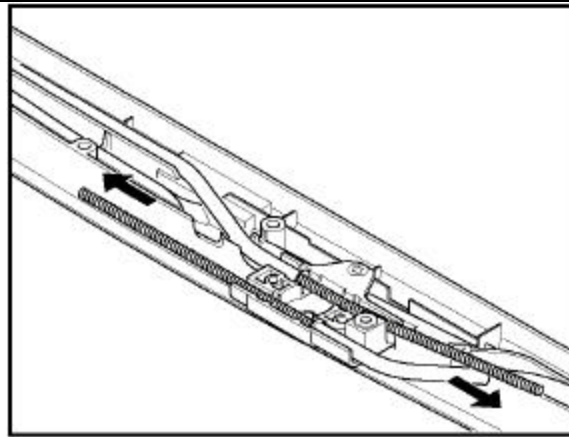

25. Close the mechanism completely by pulling the drive cable till the mechanism is placed in the closed position. Make sure that the hinge belt is not jammed between the mechanism.

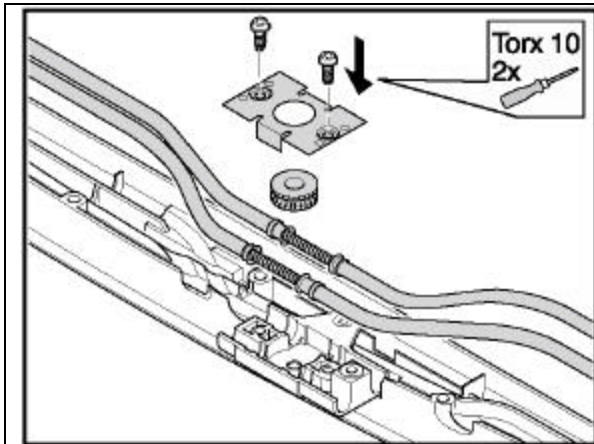

26. Mount the drive cables, gearwheel and gearwheel housing. Align the gearwheel so it is placed in the center of the gearwheel housing.

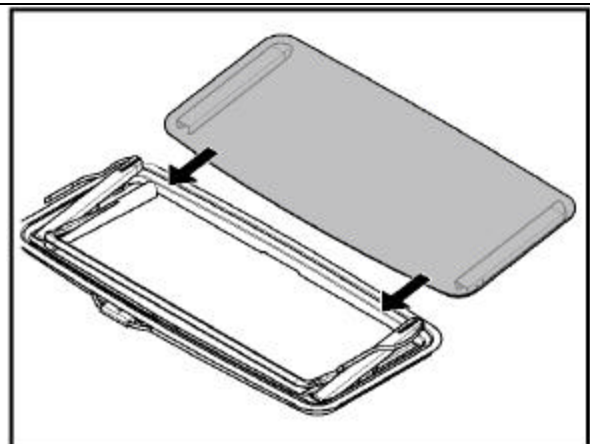

27. Slide the new glass panel parallel on the mechanism.

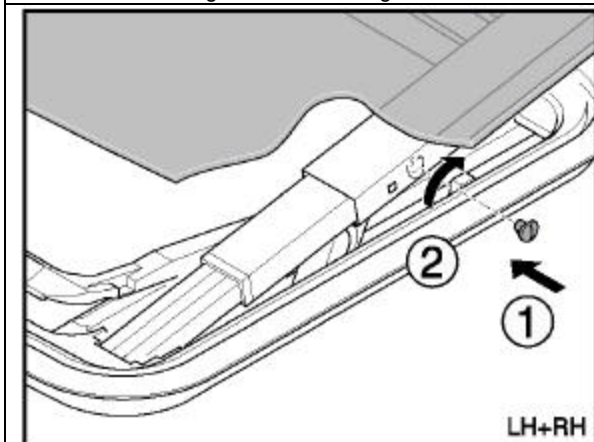

28. Mount the glass panel fixation pin and rotate it 90 degrees to lock it

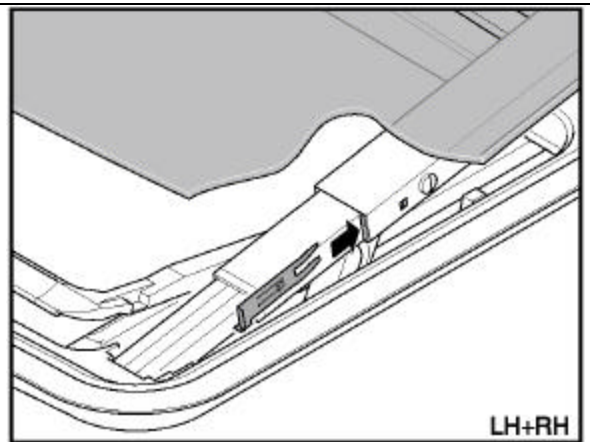

29. Slide the locking part into place to secure the glass panel fixation pin.

Continue with the instructions from 2.1.2: Installation of the sunroof.