

SEAT HEATER KIT

100% CARBON FIBER GRID

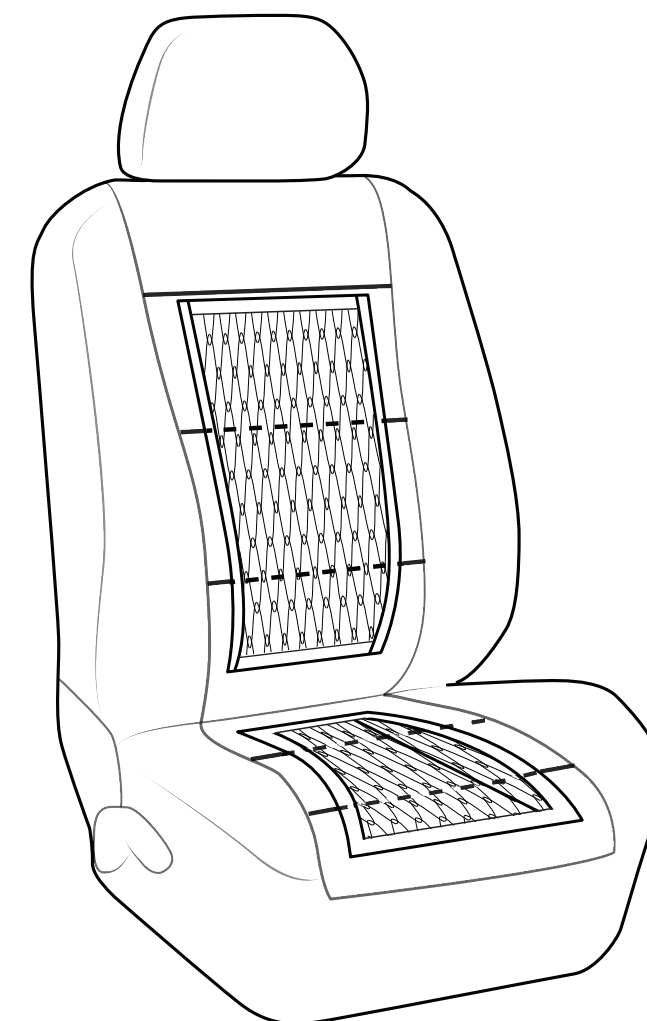

INSTALLATION GUIDE
& OWNER'S MANUAL

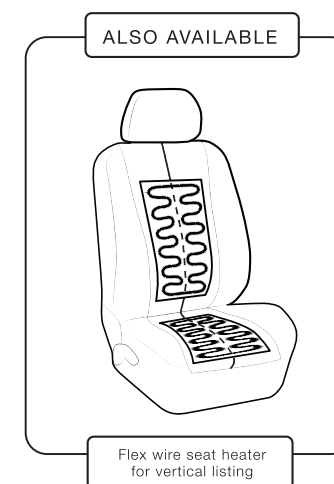

August 2012

IMPORTANT

Please register your product within 30 days after installation or you MUST retain the proof of purchase to claim warranty. Please follow guidelines on the last page to register your product.

IMPORTANT

Please register your product within 30 days after installation or you MUST retain the proof of purchase to claim warranty. Please follow guidelines on the last page to register your product.

1 WARNING:

OCCUPANCY CLASSIFICATION SENSOR

Most new cars come with an OCS in the passenger seat to help control airbag deployment. When you remove the seat cover from the seat, identify whether the seat is equipped with a Surface Mounted OCS. This sensor is usually visible and resembles flat circular or rectangular disc.

(Legend by color)

- Surface Mounted OCS
- Heating Pad

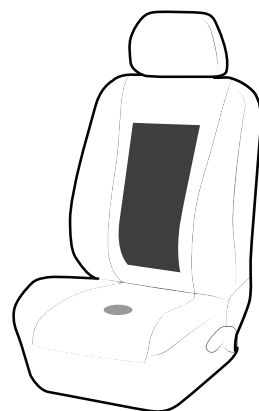

Fig. 1-1

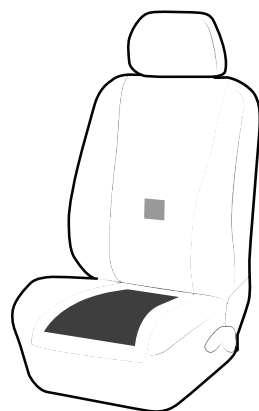

Fig. 1-2

WARNING:

OCS sensor MUST be recalibrated by authorized dealership any time seat or seat cover is removed. This ensures the safety of airbag deployment system.

If your vehicle is equipped with Surface Mounted OCS, please consult with manufacturer or dealer for Safety & Liability issues. We highly recommend that you do not install our heating pad on top of Surface Mounted OCS. If you are unsure, contact dealership or manufacturer for your specific vehicle.

In some cases BMW, Toyota, Kia and Hyundai locate OCS on seat bottom's surface whereas Honda locates OCS on the seat backrest's surface.

For Surface Mounted OCS the manufacturers usually put only one heating pad on part of the seat where there is no surface mounted OCS.

If the Surface Mounted OCS is on the seat bottom, the heating pad goes on the backrest (Fig. 1-1). If the Surface Mounted OCS is on the backrest, the pad goes on the seat bottom as shown above (Fig.1-2).

If you wish to install only one heating pad, disconnect one of the heating pads from the connector and remove it from the kit. The colors illuminated from the switch may change depending on which pad you have removed (if only one color lights up when a pad is removed, switch existing pad to other connector) :

- One connector allows 1 color to illuminate
- Other connector allows 2 colors to illuminate

6

TROUBLESHOOTING

IF

THEN

Seat Heater is not turning on
LED is NOT on

Verify the fuse and change it if necessary

Seat heater heats up but
LED stays off

LED in switch is defective

Seat Heater turns on but no
heat is feltLED turns ON

Connection from seat heater to wiring harness may have loosened. Turn off the seat heater switch and take out the vehicle's key. Now reconnect the seat heater to wiring harness until you hear a "click". DO NOT try this on your own, have a professional do that for you. If nothing of above works, you may have a defective heating pad or wiring harness. Contact your installer for more help.

Uneven heat distribution

Turn OFF the seat heater and consult with a professional installation center.

Fuse burns out repeatedly

Check fuse if it is rated at 10Amp. Consult with a professional installation center if it reoccurs.



NEED ASSISTANCE

Please contact your installer or local distributor.

FOLLOW THESE GUIDELINES ON A DAILY BASIS :

1. DO NOT operate the seat heating unit unless a passenger is sitting on it. The passenger must be able to feel heat and be able to react accordingly. DO NOT allow people who experience difficulty with feeling heat including paraplegic persons, young children and to use the seat heating unit due to the potential risk of injury or burns.

2. DO NOT leave heating unit switched on unsupervised. Caution needs to be taken when one is near the seat heater switch to avoid unintentional activation of the seat heating unit.

3. If the seat occupant feels an excessive temperature after the seat heating unit has been switched on; change to low temperature setting to reduce heat or switch off completely.

4. Do not allow heating pads to come into contact with metal or sharp objects such as knives, tools or anything which could penetrate or damage seat surface and heating pads.

5. The High setting of the seat heater is unsuitable for continuous operation as it puts load on the vehicle battery.

6. For personal safety and to prevent battery drainage, the seat heater MUST NOT be able to generate heat while the vehicle ignition is switched off.

7. The recommended location of the seat heater fuse is within 12 inches of the tapped power source.

Fuse Location for customer reference:

8. DO NOT put sharp or very heavy objects on top of the seat as they can damage seat surface and heating pads.

9. When a seat heater is switched on, do not cover the seat with insulating materials including blankets, rugs, jackets, cushions, bags, handbags, retro-fitted seat mats, children's seats, seat reinforcement etc. The function of seat heaters could be affected if it is operated while these materials are present. This can damage seat and cause injuries to seat occupant.

10. DO NOT expose the heating pad to excessive moisture. Small amounts of the following liquid does not adversely affect the heating pad from being operated safely and continuously after it has dried out: perspiration, beverages (ex. Coffee, cola, mineral water, etc.), brine (Saltwater 5% in solution), cleaning agents containing ammonia (10%) by volume, cleaning agents containing alcohol (1-% by volume), cleaning agents for plastic or vinyl or soap water.

2 COMPONENTS LIST

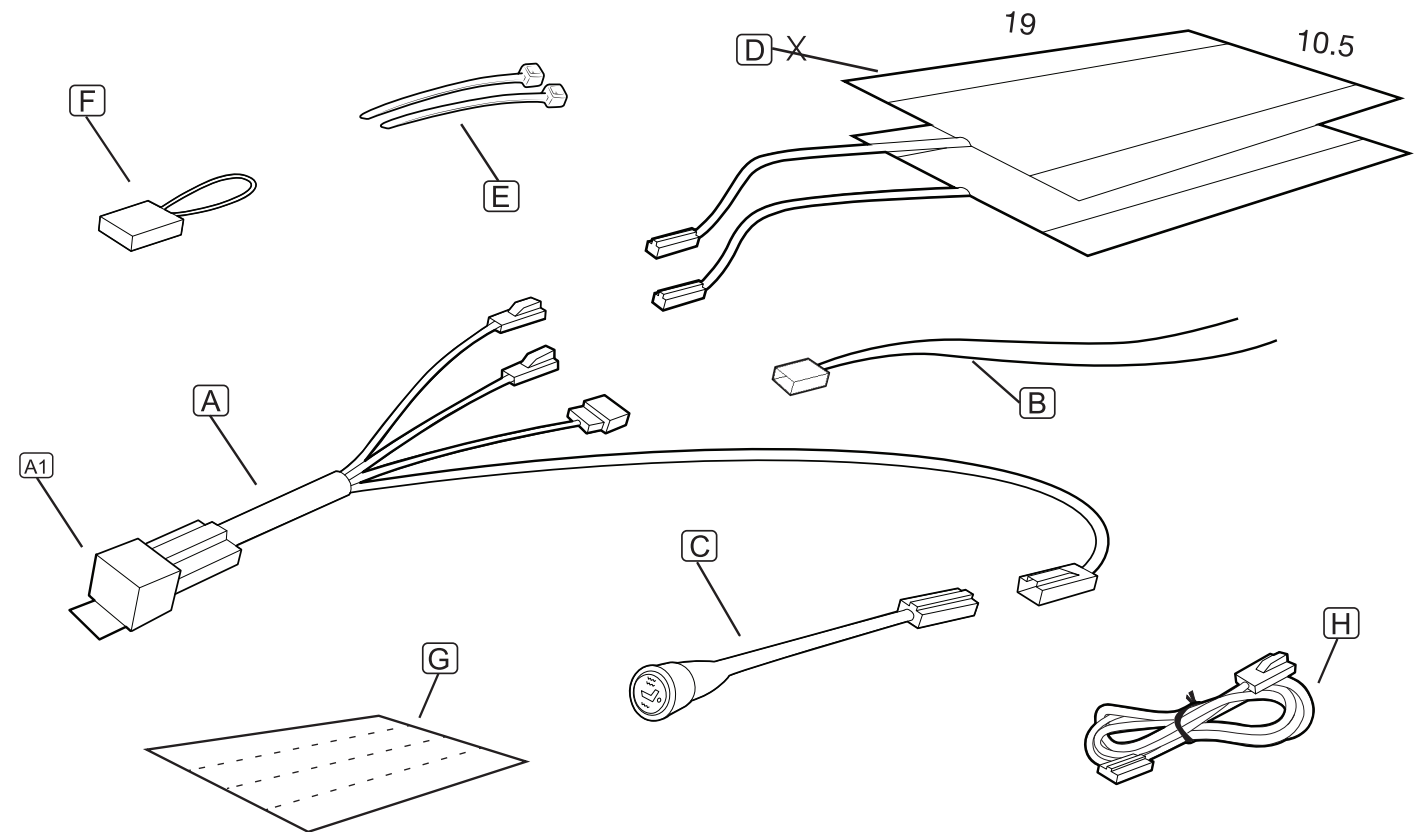

A WIRE HARNESS

A1 5 Pin Automotive Relay

B POWER WIRES

C ROUND UNIVERSAL SWITCH

21mm (13 /16 inch) Drill hole

D HEATING PADS (2)

Measuring 19 X 10.5

E ZIP TIES

F FUSE HOLDER

With 10Amp Fuse

G ADHESIVE INSULATION SHEET

H EXTENSION CORD

For Switch (Optional)

INSTALL THIS KIT ONLY WHEN :

Seat covers are completely removed from seat foam

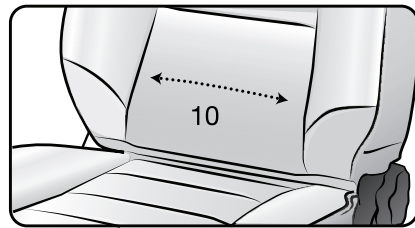

Listing channels are at least 10" (no less) apart.

Battery terminals are disconnected and Security codes for radio, navigation system, etc. have been noted

Use original kit components **ONLY**.

The kit should be installed by a qualified technician or an installer.

Follow installation procedure step by step from this manual to retain limited warranty.

Heating pads must only be modified as described under Pad Alteration Procedure described herein.

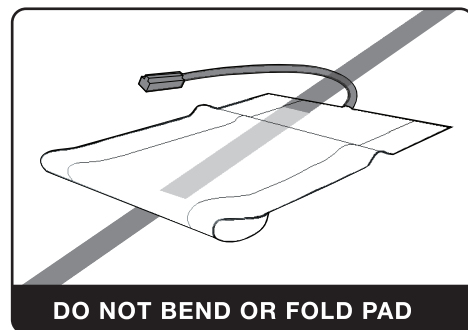

Fig. 3.2

Heating pads must be correctly positioned and secured to avoid folds and creases. Contact with sharp objects will compromise their performance.

Do not modify the seat cover or seams of seats with side air-bags; Refer to owner's manual for seats with integrated seat belts or occupant detection sensors for air bags.

Heating kit should only be operated at +12V \pm 1V. Connect it to the accessory bay in fuse box that is controlled by ignition switch. Use 10 Amp rated fuse to protect this kit. Do a continuity check on this fuse to make sure it is working. **DO NOT** connect directly to the battery to avoid **battery drainage**.

To prevent wire damage:

Do not modify wire or wire harness
Rout wires so seat can move freely
Avoid contact with sharp edges
Avoid unnecessary bending and pulling

Seat foam surface should be dry and clean. Sufficient pressure should be applied to adhesive section of pads to ensure solid bond between foam and pad. Do not reinstall a pad that has previously been adhered to seat foam.

Please explain to your customer the seat heater's functions, limitations, safety and limitations of warranty. Operating instructions must include fuse location and position.

WARNING :

Excessive contact with any liquid can adversely affect the performance of the seat heating pad and reduces its service life.

DO NOT operate seat heating pad if:

- seat is wet or damp
- occupant is wearing damp or wet clothing
- for drying clothes / objects

- IF :**
- at any time you feel that the seat heater is too hot and/or causing dizziness due to overheating.
 - an unusual smell develops when the seat heating unit is switched on or if there is an uneven heat distribution.

- THEN :**
- Switch the unit off immediately, unplug the power lead connector, and/or remove the 5 pin automotive relay (in the seat heater harness part A1 see components list) under the seat if:

If any of the above occurs, **DO NOT** use the seat heater until fixed by professional.

INSTALLATION PROCEDURE CONTINUED . . .



- Connect the positive (red) wire to the previously identified safe power source and secure the ground (black) wire to the vehicle chassis or a ground wire capable of handling the extra load.

15. Turn the vehicle to accessory position and test the high and low settings.

14. Make sure the seat heater switch is set to "off" position (middle position on the universal round switch) and connect the red cable to the positive battery post that you took off in step 2.



TESTING & OPERATION
UNIVERSAL SWITCH:

-  **HIGH** : Press the switch upward for the high setting. This is confirmed by a red light.
-  **LOW** : Press the switch downward to use the low setting. This is confirmed by a green light.
- OFF** : Press the switch to the middle for off. This is confirmed by no light. (As shown left)

4 INSTALLATION PROCEDURE

NOTICE : Follow procedure to validate warranty

1. Ensure the vehicle is on a level surface, in park and the hand brake is engaged.
2. Disconnect red cable from battery's positive terminal. Failure to do so may result in faulty system codes.
3. Unbolt the seat from floor and unplug any wires connected to the seat.
4. Wrap cloth or foam around metal feet of seat to protect interior and installer. Now carefully remove the seat from vehicle.
5. Remove backrest and seat bottom covers by detaching sewn "J" clips from one another. These clips are usually located at the bottom of the seat back. This may require the seat back to be folded all the way forward or backward depending on accessibility.
6. Place heating pads on bare foam of both backrest and seat bottom. **Write down Pad number on Product Registration Procedure (page 13, section 8, step 1).** Align pads so that wire sockets go between backrest and seat bottom (See Fig. 4-1). Using a pen or permanent marker, mark the area to be cut from each pad for seat listings to be reattached to the seat. Follow Pad Alteration Procedure.

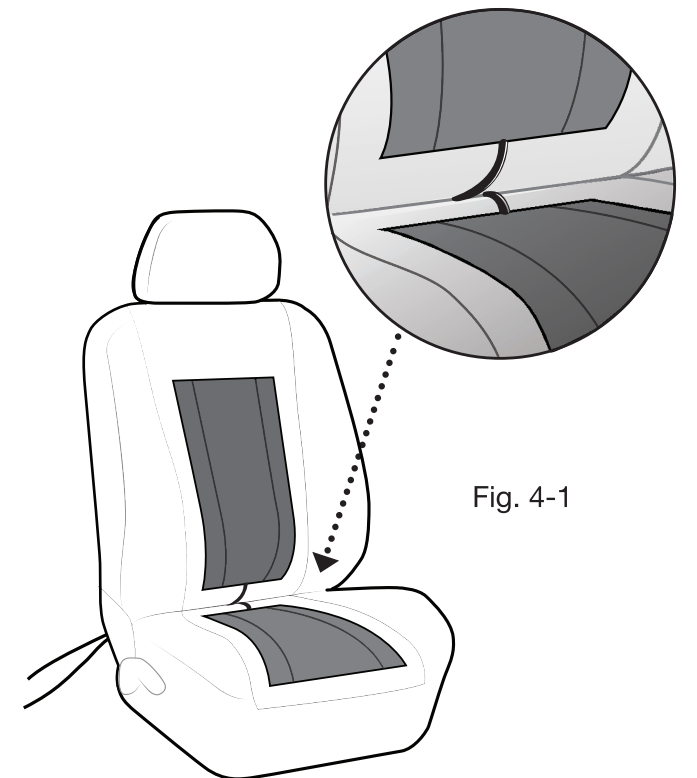
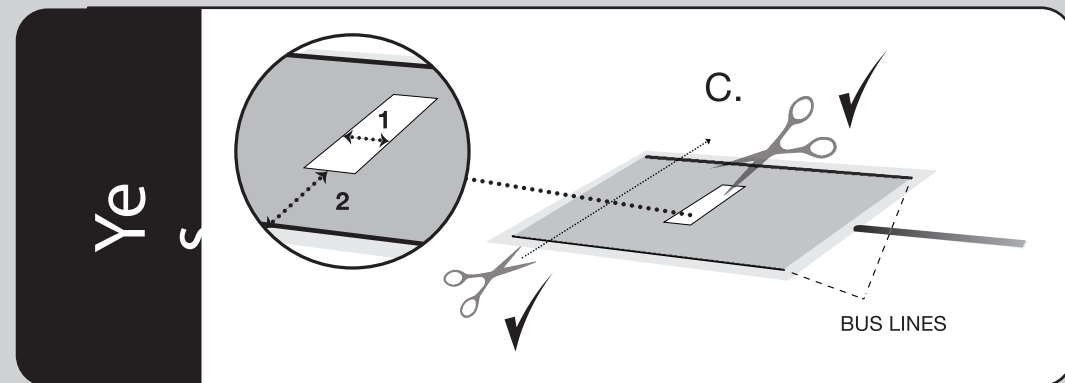
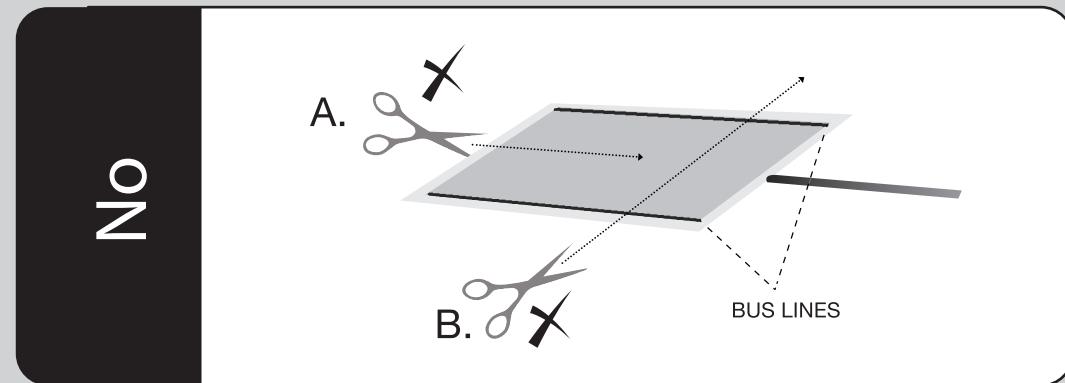

Fig. 4-1

PAD ALTERATION PROCEDURE :

Note: The smaller the cut - the more the heat.



A. DO NOT cut down in length of the heating pad as shown in Fig A. Doing so will completely damage the pad.

B. DO NOT cut bus lines for making room for listings as shown in Fig. B.

C. You may cut a strip no thicker than 1 inch across width of pad to allow seat upholstery reattachment to seat frame. Leave at least 2 inches space from bus lines. See Fig. C.

D. Do not bend or fold the pad. Doing so will cause a short circuit.

INSTALLATION PROCEDURE CONTINUED . . .

7. Carefully cut away the marked material with scissors making sure NOT to cut the bus line.
8. Remove the adhesive tape backing from the bottom side of the seat heater pad and carefully place the pad on the seat in the desired location. The holes you cut should align with the listings or velcro attachment locations. Make sure pad is not bent and folded (See Fig. 3-2 on page 5). This step is crucial in maintaining safety and warranty of this product. You can also use the Adhesive Insulation Sheet from the kit to secure properly.
9. After securing the heating pad to seat foam, put the seat cover back on with any seat plastics or upholstery that you previously took out.
10. Locate an onboard accessory triggered power source (supplies current only when the key is in ACC position) which is able to deliver up to 8 Amp current. This source may be located in your vehicle's fuse box,
 - See the vehicle owner's manual to help find the location of an appropriate power source or talk to your supplier about other options (such as fuse stackers or Power Distribution Modules). DO NOT connect it directly to the battery.

- Doing so will cause battery drainage when engine is not running.

11. Once a power source is located, extend the "Power Wires" underneath the vehicle's trim or carpet to the seat bottom. Keep enough length for the seat to slide all the way forward and backward. Make sure the end with a connector is the end by the seat. Never install wiring directly under an occupant's feet area.
12. Find a suitable surface that is flush and has enough space to fit the universal switch and wires behind it. Switches are often installed on either the plastic section of the seat's side or in the center - portion of the dash. Once you have found the right location, drill a 21mm (13 /16 inch) hole through the desired surface and pull the switch wiring pigtail through the hole. Attach the switch wiring pigtail to the main wiring harness (underneath the trim) and push the switch firmly in the hole until you hear a "Click".
13. Mount the seats in the vehicle and plug in the seat's previously disconnected wires. If you have disconnected the "Power wires" you ran in Step 11 from wiring harness, connect them to the wiring harness.

. . .