

PACIFIC HEAT

Seat Heater System

INSTALLATION GUIDE
& OWNER'S MANUAL

SH-R-04

- *Parallel Conductor Buss Construction*
- *100% Carbon Fiber Grid*

Create Your
PREMIUM KIT

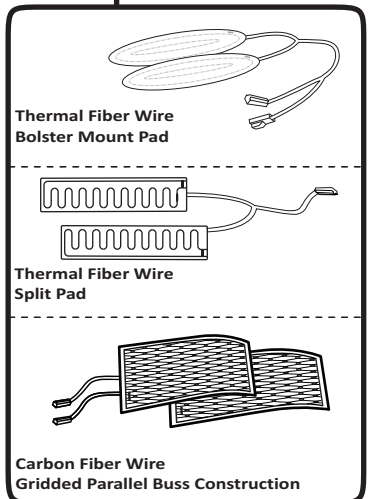
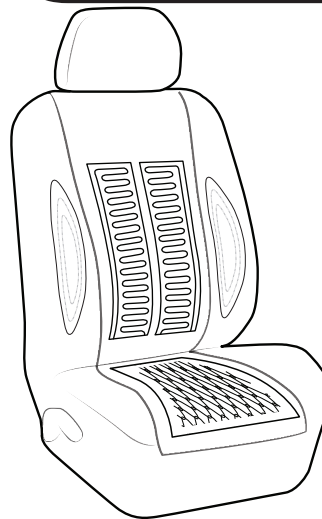

AVAILABLE PAD STYLES

ACCESSORIES

Part# SH-R-EXTp

HEAT PAD EXTENSION CORD

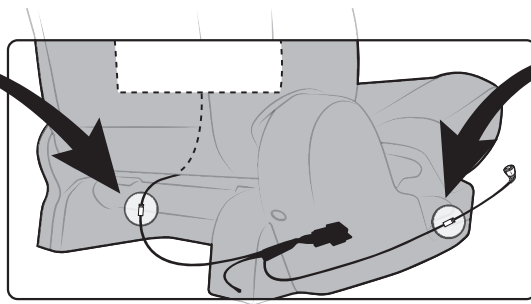
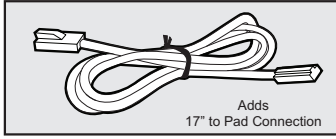

Part# SH-R-EXTs

SWITCH EXTENSION CORD

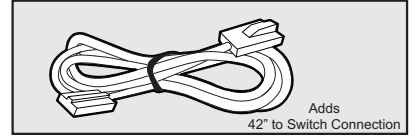

Thermal Fiber Wire Seat Heater Kit

Complete Kit:
Part# SH-S-03

Single Pad:
Part# SH-S-pd

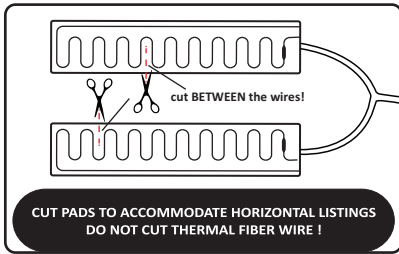
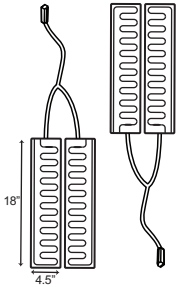

Create Your Custom Seat Heater with Pacific Heat Interchangeable Parts

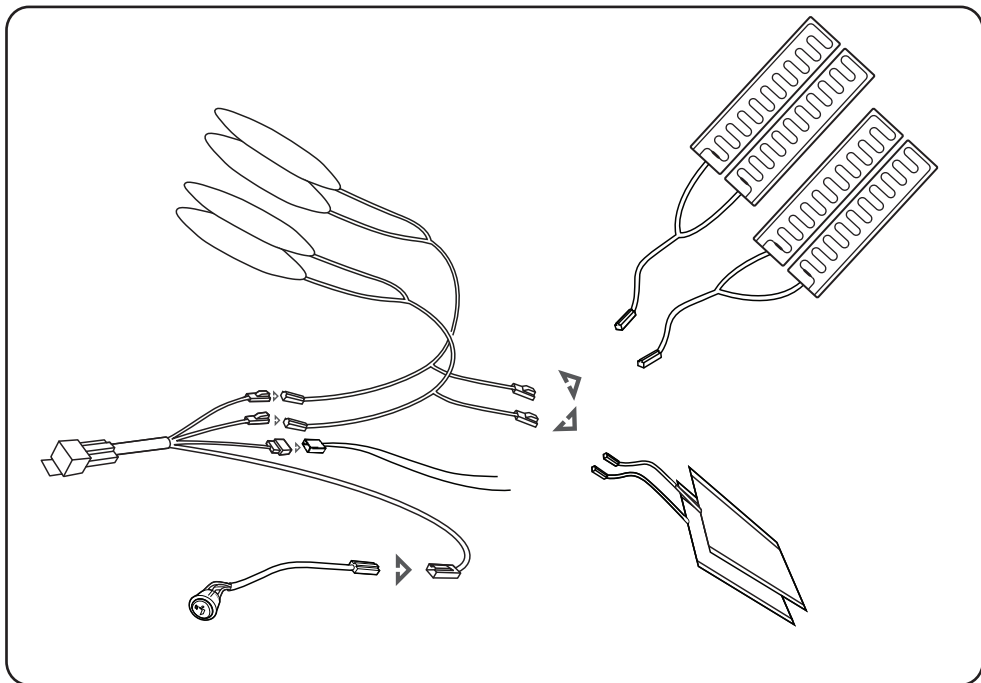

Bolster-Mount Accessory Heat Pads

Accessory Set:
Part# SH-B-03

Single Pad:
Part# SH-B-pd

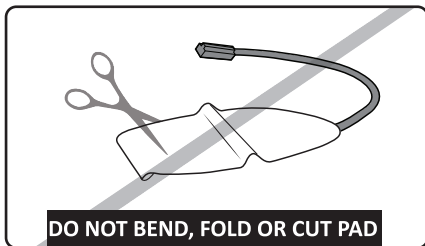
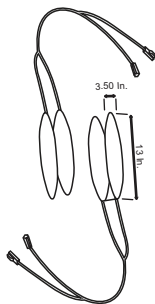

INSTALL SEAT HEATERS UNDER SEAT COVERS THAT ARE IN GOOD CONDITION ONLY; I.E. NO RIPS, TEARS, HOLES. ETC. TO ENSURE THE SAFETY OF PASSENGERS AND OPTIMAL SEAT HEATER PERFORMANCE.

ALSO AVAILABLE:

FUSE STACKERS Power Distribution Installation Accessories

No Place For Another Fuse?
Try Our Fuse Stackers!

SOLD in 10 Packs

For Mini Fuse

Part# F-ATMN-10

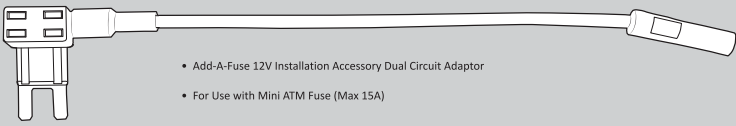

- Add-A-Fuse 12V Installation Accessory Dual Circuit Adaptor
- For Use with Mini ATM Fuse (Max 15A)

For Micro2 Fuse

Part# F-MCR2-10

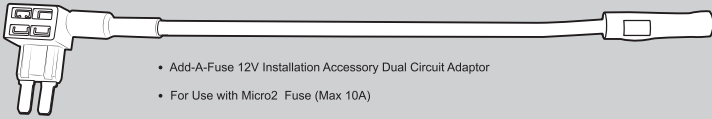

- Add-A-Fuse 12V Installation Accessory Dual Circuit Adaptor
- For Use with Micro2 Fuse (Max 10A)

For Low-Profile Mini Fuse

Part# F-LPMN-10

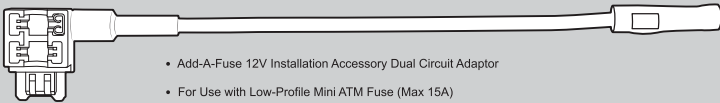

- Add-A-Fuse 12V Installation Accessory Dual Circuit Adaptor
- For Use with Low-Profile Mini ATM Fuse (Max 15A)

For Standard Fuse

Part# F-ATCN-10

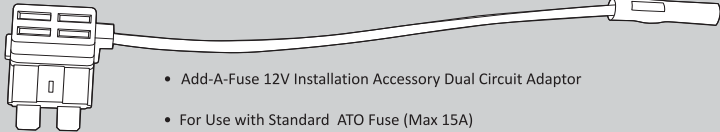

- Add-A-Fuse 12V Installation Accessory Dual Circuit Adaptor
- For Use with Standard ATO Fuse (Max 15A)

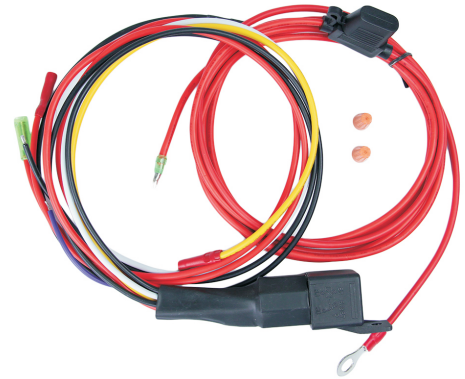

POWER DISTRIBUTION BYPASS MODULE

Avoid System Interference With Your 12V Automotive Installations
Source CLEAN Power Directly from your Alternator or Battery!
Single Accessory Installation or Combined Load up to 25A



Part# PDM-ME1



HOTSHOT

THERMAL WINDSHIELD WASHER FLUID DEVICE
A Safe, Convenient and "Hands Free" Way To Keep Your Windshield Clear - All Year Round!



Part# AT-38-OD

Contact Your Supplier For More Information On These Products

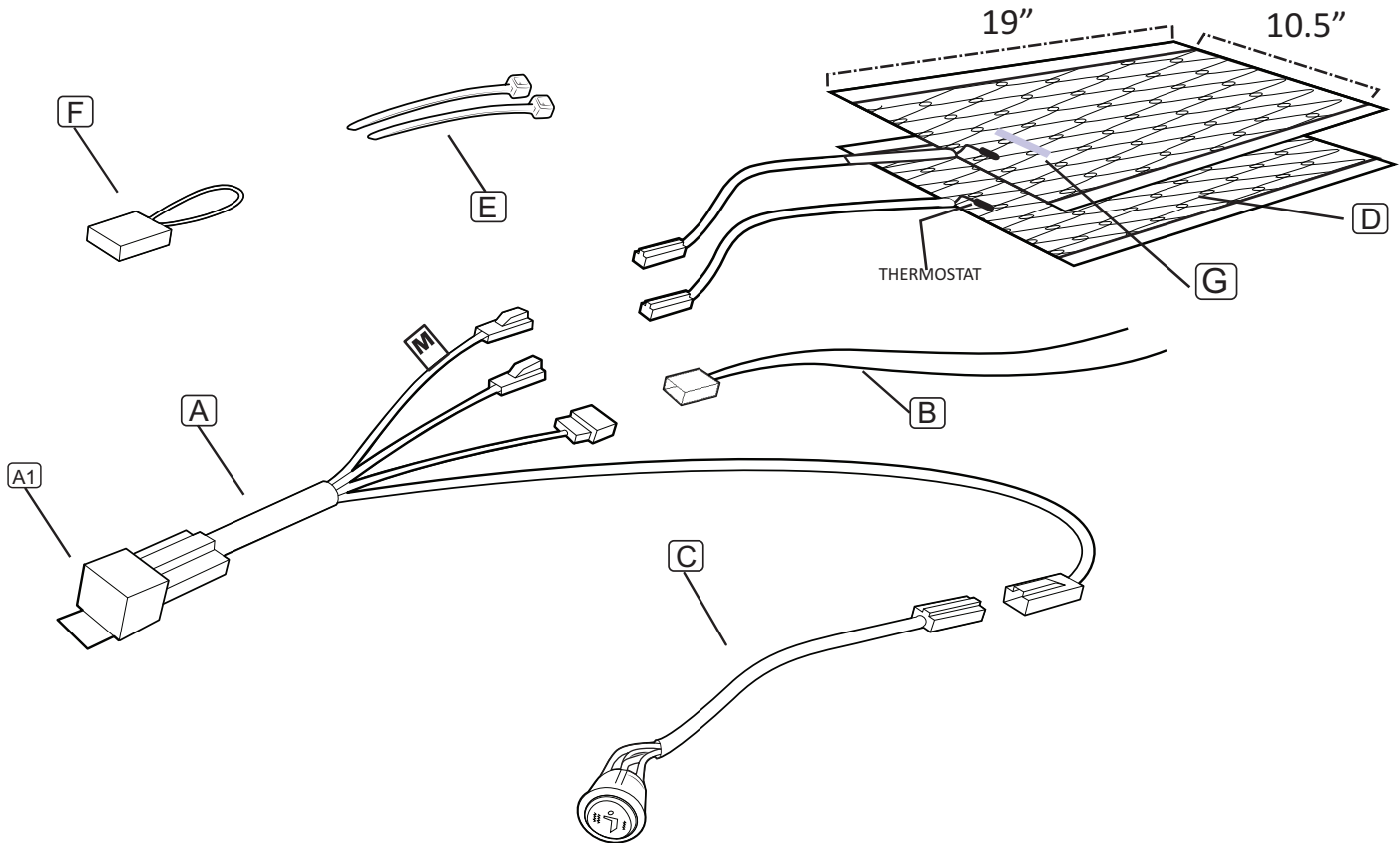

- A** Central Wiring Harness Assembly
A1 5 Pin Automotive Relay

- B** Power/Ground Wire Leads

- C** Dual Temperature Round Rocker Switch

Black with white seat heater symbol
 Requires a 21mm (13/16 inch) Drill Hole

- ⚡ Illuminates RED on HIGH Setting
- ⚡ Illuminates GREEN on LOW Setting

- D** Carbon Fiber Heating Pad Elements
 • Two (2) Rectangular Pads;

- Harness Pad Wire Lead Tagged "M" will be the MASTER PAD plug-in
 Install the MASTER PAD on the BACKREST

- 19" Long x 10.5" Wide

- E** Cable Ties ("Zip" Ties)

- F** Fuse Holder
 With 7.5Amp Fuse

- G** PAD ID # STAMP

2 USING PACIFIC HEAT WITH OCS SENSORS

This section addresses necessary precautions regarding Pacific Heat and your side impact air bag safety features, should your vehicle have this equipment. If your vehicle has an air bag system, your front passenger seat *may* be equipped with an **OCS sensor**.

What is an OCS Sensor?

OCS is an acronym for Occupancy Classification System.

An OCS Sensor is a device which senses the presence of a person occupying the front right seat component.

Your vehicle's computer uses this data to activate the air bag safety feature for that seat component.

There are 3 (three) types of OCS sensors commonly in use:

ATTENTION

OCS SENSORS OF ANY TYPE MUST BE RE-CALIBRATED BY AN AUTHORIZED DEALERSHIP OR PERSON ANY TIME THE SEAT COVER IS REMOVED.

THIS WILL ENSURE THE CONTINUED SAFE FUNCTIONING OF YOUR VEHICLE AIR BAG DEPLOYMENT SYSTEM

> Rail Mount OCS Sensor <

OK to use regular installation of Pacific Heat on seats



The seat heater pad does not interfere with OCS sensor
Sensor is located on the seat rails near the floor

> Silicon Gel Bladder OCS Sensor <

OK to use regular installation of Pacific Heat on seats



The seat heater pad does not interfere with OCS sensor
Sensor resides in metal pan/seat support under the seat foam

> OCS SEAT SENSOR MAT<

Located on the FOAM SURFACE of either cushion or backrest



IT IS NOT RECOMMENDED TO INSTALL ANY SEAT HEATER PAD WHERE A SEAT SENSOR MAT IS PRESENT

HOW TO SAFELY INSTALL PACIFIC HEAT On Seats with An OCS Sensor Mat

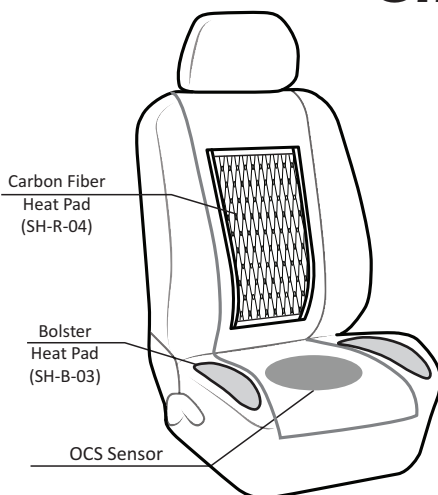

Fig. A



You Will Need:

Pacific Heat Bolster Mount
Accessory Heating Pads
(SH-B-03)

- Remove the seat cover to determine the location of the seat sensor mat.
- Replace the appropriate seat heater pad from SH-R-04 or SH-S-03 with a bolster seat heater pad from SH-B-03 **See ** Note Below**
- If sensor is on the central cushion (**Fig. A**) then use the bolster pad on the cushion bolsters.
If sensor is on the central backrest (**Fig. B**) then use the bolster pad on the backrest bolsters.

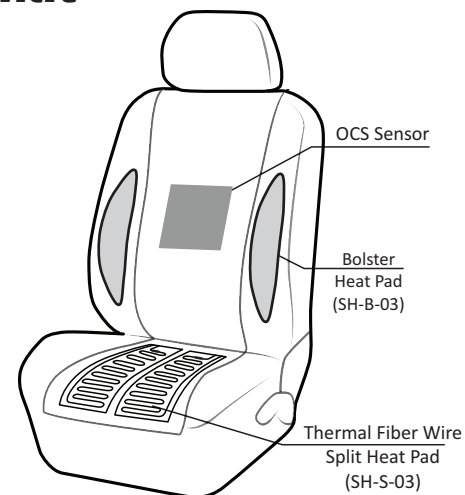

Fig. B



**Note:

Some vehicles have a sensor mat which extends out over the bolsters (e.g. Mini Cooper). Please be advised that it is not recommended to install ANY kind of seat heater pad over this sensor!

Contact Your Supplier About Obtaining Pacific Heat Bolster Mount Accessory Pads Today !

3 INSTALLATION GUIDELINES

Before Beginning Your Installation:

- Have your seat heater kit installed by a qualified technician or installer.
- Use original Pacific Heat Seat Heater components only
- Disconnect vehicle battery terminals. Be sure to take note of any electronics security codes (navigation system, etc) prior to disconnection.
- This equipment is for installation UNDER the factory upholstery. Your upholstery must be REMOVEABLE to use this heater. It is not recommended to install Pacific Heat under bonded seat skins. Any Pacific Heat installed under bonded seat skins is not warranted.
- It is important to follow this installation procedure step by step.

Hey! Just Sayin' ...

Do your self a favor....read the guide!
Things do change now and again...
Keep Yourself on the Leading Edge! :)

- Seat heater pads must be installed 100% contoured to the seat foam. This means the pad should be free of any folds, bends, creases or gathers.
- The pad should have a solid bond to the foam such that it will remain COMPLETELY STATIONARY throughout its usage after the installation is complete. It is suggested to use extra adhesive to cover the entire bottom of the pad to achieve this. 3M Adhesive Spray or heavy duty double sided carpet tape works great to achieve this.

Hey! Just Sayin' ...

There should be **no chance of shifting** for your seat heater pad once your upholstery is re-installed.
Use what ever adhesion you like...as long as it is non-flammable when fully dry....

- Refer to Page 8 of this guide for instruction on how to cut pad for fitting.
- Route wires so that they are protected and not stressed while still allowing the seat components to move freely.
- Route Pad lead wires so that they extend out the rear of the seat - not the front of the seat. **Premature wire fatigue can result from in/out passenger movement if the wires are extended out the front of your seat.**
- Ensure the area of installation is free of sharp objects to safeguard against unintended pad damage during and after your install.
- Do not modify seat covers or seams of seat with side impact air bag safety features. Only the listing wire casing/pockets may be modified if present.
- Consult the parts department of a car dealership that sells your vehicle to determine the presence of an air bag sensor on the front passenger seat.

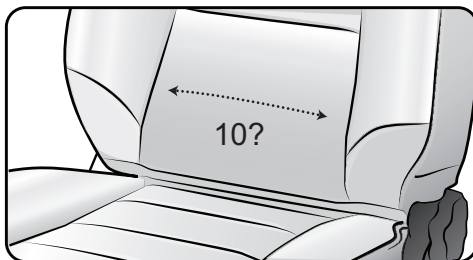
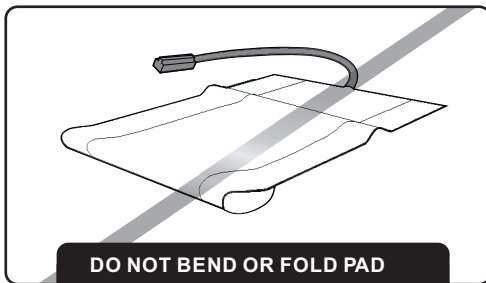

Listing channels are at least 10? apart.

IMPORTANT
Please Read

The installation method laid out in this manual affords the highest level of user safety and optimal performance for this equipment. Warranty for this equipment remains valid ONLY when the installation method and recommendations presented within this manual are fully adhered to.

4

INSTALLATION PROCEDURE

This seat heater kit should be operated at 12V +/- 1 V and connected into your vehicle's electrical circuitry as a 'switched' appliance.

It should only be able to operate when your ignition is ON.

Its up to you where you want to grab power from as long as it is a 'switched' source for the seat heater.

1. Ensure the vehicle is on a level surface, in park and the hand brake is engaged.
2. Disconnect red(positive) battery cable. Failure to do so may result in faulty system codes.
3. Unbolt the seat from floor and unplug any wires connected to the seat.
4. Wrap cloth or foam around metal feet of seat to protect interior and installer. Now carefully remove the seat from vehicle.
5. Remove backrest and seat bottom covers by detaching sewn "J" clips from one another. These clips are usually located at the bottom of the seat back. This may require the seat back to be folded all the way forward or backward depending on accessibility.

6. Place heating pads on bare foam of both backrest and seat bottom. **Write down Pad ID # on the Product Registration Form (page 14).**

Align pads so that wire sockets go between backrest and seat bottom (See Fig. 4-1).

Using a pen, mark the area to be cut from each pad for seat listings to be reattached to the seat.

Be sure to place the MASTER PAD on the BACKREST !

Placing the master pad on the backrest will result in a more consistent cycling of the thermostats in the seat heater circuitry.

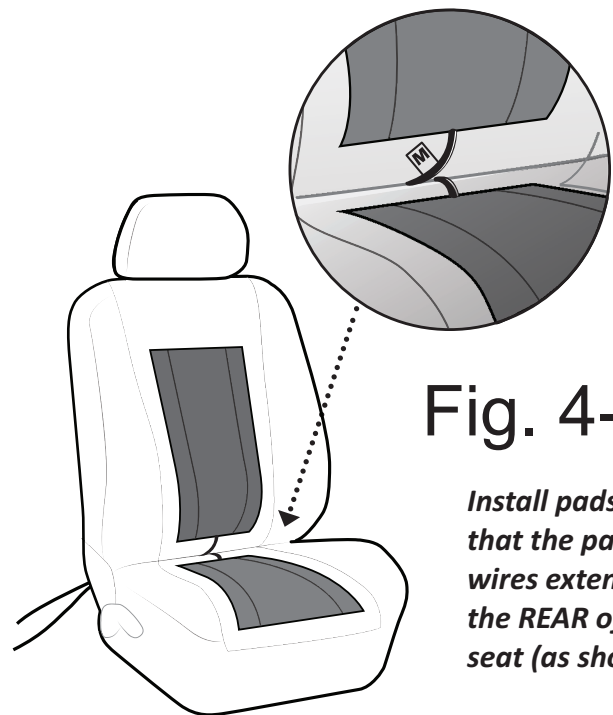

Fig. 4-1

Install pads such that the pad lead wires extend out the REAR of the seat (as shown).

IMPORTANT
Please Read

The installation method laid out in this manual affords the highest level of user safety and optimal performance for this equipment. Warranty for this equipment remains valid ONLY when the installation method and recommendations presented within this manual are fully adhered to.

HOW TO MODIFY THE PAD FOR FIT

No

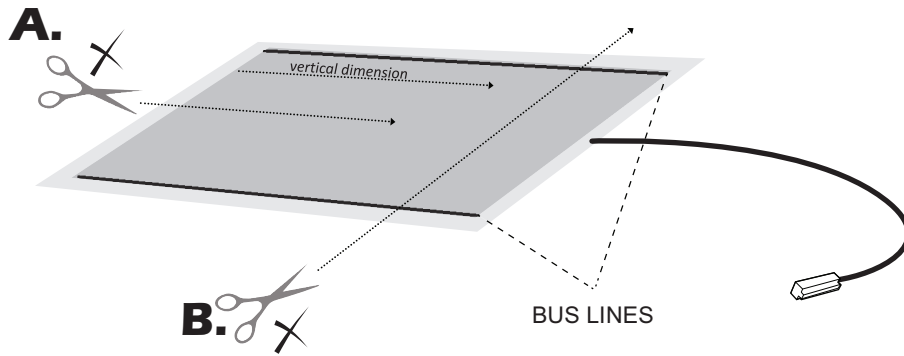

A. DO NOT cut the pad so that you have one long cut down the vertical dimension of the pad.

B. DO NOT make the pad any shorter than 12" in length

Yes

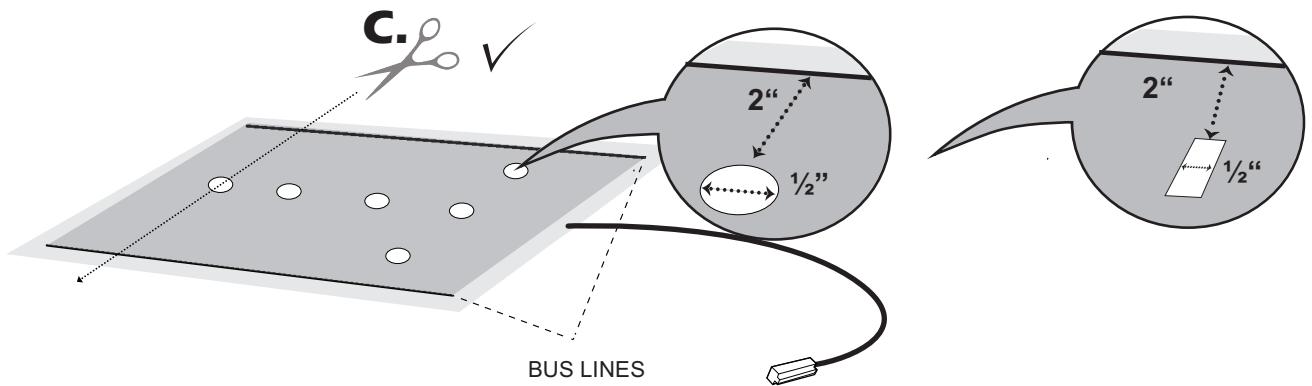

C. You may remove up to a maximum of 7 inches if you wish to shorten the seat heater pad. Use a SHARP cutting tool to make a clean cut straight across from one side to the other. ***The width of the pad may not be changed.***

Use a SERIES of holes or small rectangles to make room for your listing wire casing.

Hole edges ***must*** have a minimum of $\frac{1}{2}$ " clearance to avoid contacting each other after installation. ***DO NOT USE A RAZOR CUT SLIT AS A HOLE. This has a high potential to create a burn.***

Create TABS in your listing wire casing to fit down through the holes FIRST before inserting the listing wire for attachment to the seat frame.

IMPORTANT
Please Read

The installation method laid out in this manual affords the highest level of user safety and optimal performance for this equipment. Warranty for this equipment remains valid ONLY when the installation method and recommendations presented within this manual are fully adhered to.

INSTALLATION PROCEDURE CONTINUED . . .

7. Carefully cut away the marked material making sure NOT to cut the conductor buss lines.

- DO NOT connect it directly to the battery. Doing so will cause battery drainage when engine is not running.

8. Remove the adhesive tape backing from the bottom side of the seat heater pad and carefully place the pad on the seat in the desired location. The holes you cut should align with the listing.

Make sure pad is not bent and folded (See Fig. 3-2 on page 5). This step is crucial in maintaining safety and warranty of this product.

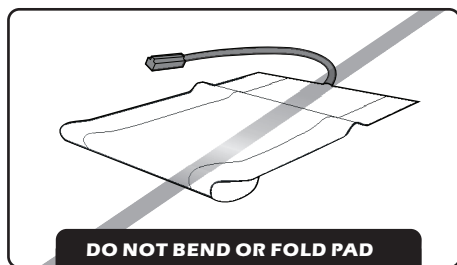

Fig. 3.2

9. After securing the heating pad to seat foam, put the seat cover back on with any seat plastics or upholstery that you previously took out.

10. Locate an onboard accessory triggered power source (supplies current only when the key is in ACC position) which is able to deliver up to 8 Amp current. This source may be located in your vehicle's fuse box,
- See the vehicle owner's manual to help find the location of an appropriate power source or talk to your supplier about other options (such as "Fuse Stackers" or "Power Distribution Bypass Modules").

11. Once a power source is located, extend the "Power Wires" underneath the vehicle's trim or carpet to the seat bottom. Keep enough length for the seat to slide all the way forward and backward. Make sure the end with a connector is the end by the seat. Never install wiring directly under an occupant's feet area.

12. Find a suitable surface that is flush and has enough space to fit the universal switch and wires behind it. The switch is often installed on either the plastic section of the seat's side or in the center - portion of the dash. Once you have found the right location, drill a 21mm (13 /16 inch) hole through the desired surface and pull the switch wiring pigtail through the hole. Attach the switch wiring pigtail to the main wiring harness (underneath the trim) and push the switch firmly in the hole until you hear a "Click".

The switch head is keyed (notched) so that you may align it properly in your mounting hole. This notch is located on the side of the switch head opposite to the LED and is 7/16" in length.

IMPORTANT
Please Read

The installation method laid out in this manual affords the highest level of user safety and optimal performance for this equipment. Warranty for this equipment remains valid ONLY when the installation method and recommendations presented within this manual are fully adhered to.

INSTALLATION PROCEDURE CONTINUED . . .

13. Mount the seats back into the vehicle and reconnect any previously disconnected wires

Ensure the seat heater power wires are securely connected into your seat heater main harness assembly.

Connect the seat heater HOT wire (red) to the previously identified safe power source. Secure the seat heater GROUND (black) wire to the vehicle chassis, or, a ground wire capable of handling the extra load.

The seat heater draws 5.0A - 5.8A on HIGH at a voltage of 13.8V. 13.8 V is the typical regulated operating value for most automotive electrical systems after warm-up.

In-Pad thermostats are rated for 75°C (167°F)

14. Make sure the seat heater switch is set to "off" position (middle position on the universal round switch) and connect the red cable to the positive battery post that you took off in step 2.

15. Turn on the ignition to the accessory position and test the HIGH and LOW settings

TESTING & OPERATION

SH-R-03sw: Universal Dual Temperature Seat Heater Switch

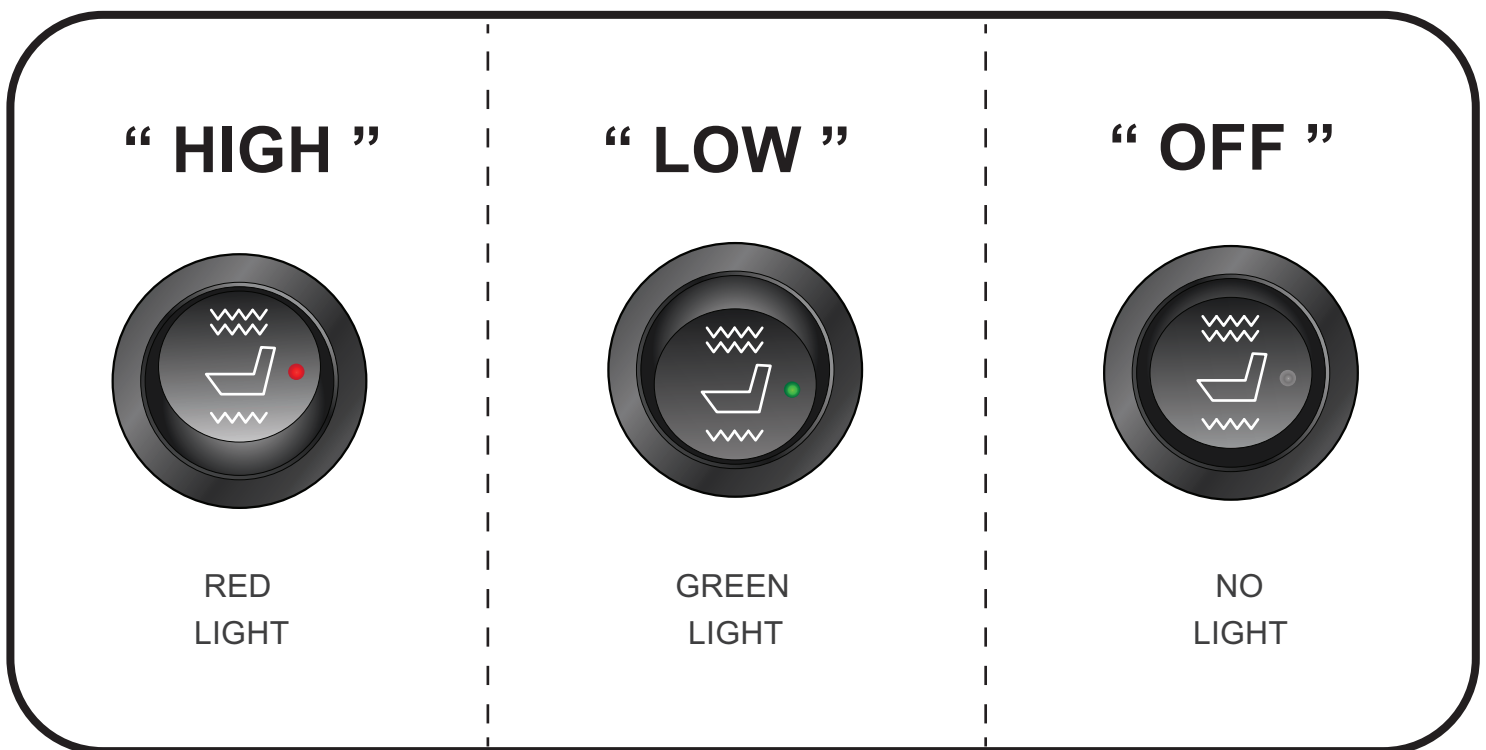

IMPORTANT
Please Read

The installation method laid out in this manual affords the highest level of user safety and optimal performance for this equipment. Warranty for this equipment remains valid ONLY when the installation method and recommendations presented within this manual are fully adhered to.

WARNING !

Excessive contact with any liquid can adversely affect the performance of the seat heating pad and reduces its service life.

DO NOT OPERATE SEAT HEATING PAD :

- if seat is wet or damp
- if occupant is wearing damp or wet clothing
- for drying clothes / objects

TURN OFF THE SWITCH IF :

- at any time you feel that the seat heater is too hot and/or causing dizziness due to overheating.
- an unusual smell develops when the seat heating unit is switched on or if there is an uneven heat distribution.

If any of the above occurs, turn off your seat heater and have your equipment checked by your installer.

USER SAFETY GUIDELINES CONTINUED . . .

Follow these guidelines on a daily basis :

1. DO NOT operate the seat heating unit unless a passenger is sitting on it. The passenger must be able to feel heat and be able to react accordingly. DO NOT allow people who experience difficulty with feeling heat including paraplegic persons, and young children to use the seat heating unit to avoid potential injury.
2. DO NOT leave heating unit switched on unsupervised. Caution needs to be taken when one is near the seat heater switch to avoid unintentional activation of the seat heating unit.
3. If the seat occupant feels an excessive temperature after the seat heating unit has been switched on; change to low temperature setting to reduce heat or switch off completely.
4. Do not allow heating pads to come into contact with metal or sharp objects such as knives, tools or anything which could penetrate or damage seat surface and heating pads.
5. The “High” setting of the seat heater is unsuitable for continuous operation as it puts load on the vehicle battery.
6. For personal safety and to prevent battery drainage, the seat heater MUST NOT be able to generate heat while the vehicle ignition is switched off.
7. The recommended location of the seat heater fuse is within 12 inches of the tapped power source.

Fuse Location – for customer reference:

8. DO NOT put sharp or very heavy objects on top of the seat as they can damage seat surface and heating pads.
9. When a seat heater is switched on, do not cover the seat with insulating materials including blankets, rugs, jackets, cushions, bags, handbags, retro-fitted seat mats, children’s seats, seat reinforcement etc. The function of seat heaters could be affected if it is operated while these materials are present. This can damage seat and cause injuries to seat occupant.
10. DO NOT expose the heating pad to excessive moisture. Small amounts of the following liquid does not adversely affect the heating pad from being operated safely and continuously after it has dried out: perspiration, beverages (ex. Coffee, cola, mineral water, etc.), brine (Saltwater – 5% in solution), cleaning agents containing ammonia (10%) by volume), cleaning agents containing alcohol (1-% by volume), cleaning agents for plastic or vinyl or soap water.

PLEASE ENSURE YOUR SEAT HEATER IS INSTALLED AS AN IGNITION TRIGGERED 12V ACCESSORY.

6 TROUBLE-SHOOTING

| IF | THEN |
|---|---|
| Seat Heater is not turning on LED is NOT on | Verify the fuse and change it if necessary |
| Seat heater heats up but LED stays off | LED in switch is defective |
| Seat Heater turns on but no heat can be felt LED turns ON | Connection from seat heater to wiring harness may have loosened. Turn off the seat heater switch and take out the vehicle's key. Now reconnect the seat heater to wiring harness until you hear a "click". DO NOT try this on your own, have a professional do that for you. If nothing of above works, you may have a defective heating pad or wiring harness. Contact your installer for more help. |
| Uneven heat distribution | Turn OFF the seat heater and consult with a professional installation center. |
| Fuse burns out repeatedly | Check fuse if it is rated at 7.5 Amp. Consult with a professional installation center if it reoccurs. |



NEED ASSISTANCE?

Please contact your installer or local distributor.

IMPORTANT Please Read

The installation method laid out in this manual affords the highest level of user safety and optimal performance for this equipment. Warranty for this equipment remains valid ONLY when the installation method and recommendations presented within this manual are fully adhered to.

7 WARRANTY (LIMITED NON-TRANSFERABLE)

- ▶ PACIFIC HEAT SEAT HEATERS ARE WARRANTED TO BE FREE OF DEFECTS IN MATERIALS AND WORKMANSHIP FOR A PERIOD OF 3 YEARS / 36, 000 MILES (60,000 KILOMETERS) WHICHEVER OCCURS FIRST. THIS WARRANTY IS EXTENDED TO THE "ORIGINAL" END USER OF THE PRODUCT AND IS NOT TRANSFERABLE IF THE VEHICLE IS SOLD/GIVEN TO A NEW OWNER

WARRANTY COVERS EQUIPMENT ONLY AND DOES NOT COVER LABOR / FREIGHT FOR REPLACEMENT PARTS

THE FOLLOWING VOIDS THIS WARRANTY:

1. If the "Installation Guidelines", "Pad Alteration - Procedure", and "User Safety Instructions" of this handbook are not followed completely and accurately. (*Incorrect Installation*)
2. Any unauthorized repair made to the seat heater.
3. Modification of the seat heater harness/connectors. (*Modifications may be done to the PADS only in the way specified in this installation guide.*)

WARRANTY LIMITATIONS:

1. Replacement Parts are covered for six months or the remainder of the original warranty period - whichever is longer.
2. In the event of a burn on the seat cover and/or foam, the replacement of parts only are covered. Photo documentation is required and in most cases the parts must be returned for examination.
3. Damage to product in transit is not covered. This claim must be filed with courier.
4. **ONE YEAR WARRANTY ONLY ON SWITCH SH-R-03sw.**
5. Labor is not covered under this warranty - equipment only -

ORIGINAL END USER'S RESPONSIBILITY:

Proof of purchase must be retained to claim warranty. Warranty is only valid if your product is registered within 30 days after installation.

8 PRODUCT REGISTRATION

- 1 Please retrieve the following information before you register your product.

PAD ID #: _____ (SEE DIAGRAM Page 4)
Installation Company : _____
Purchase Date : _____ Installation Date : _____
Vehicle Make : _____ Vehicle Model : _____
Vehicle Year : _____
Mileage at Installation : _____ COMPLETE VIN # : _____

- 2 EMAIL above details to : info@pacificrestyling.com

PLEASE SUBMIT YOUR REGISTRATION DETAILS FROM A VALID EMAIL ADDRESS FOR YOU THAT YOU CHECK ON A REGULAR BASIS. YOUR REGISTRATION NUMBER WILL BE SENT BACK TO THE EMAIL ADDRESS THAT YOU PROVIDE WITHIN 48-72 BUSINESS HOURS OF YOUR REGISTRATION SUBMISSION. PLEASE BE SURE TO INCLUDE YOUR FULL VIN NUMBER.

Create YOUR Premium Kit!

**Modular Connections !
Fully Interchangeable Parts !
Mix & Match For A 100% Custom Fit !**

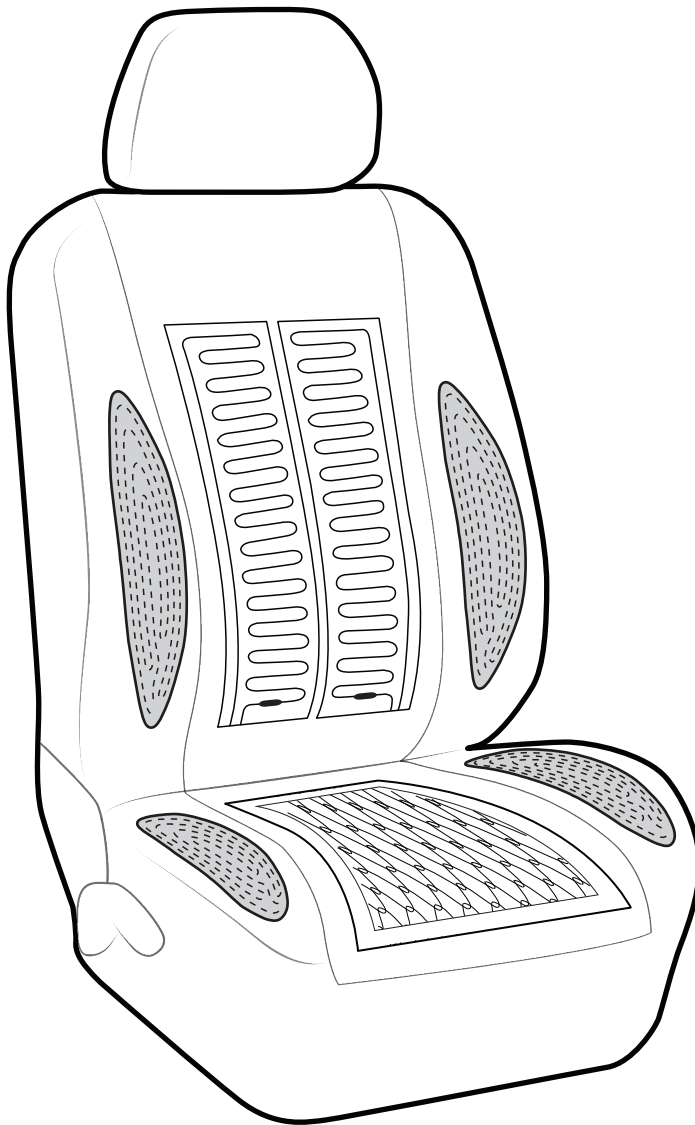

“ HIGH ”
(RED LIGHT)



“ LOW ”
(GREEN LIGHT)



“ OFF ”
(NO LIGHT)



Installer's Notes:

Install Date: _____